

**CORRIGENDUM-2**

**GeM Tender No. GEM/2025/B/5833797**

This **Corrigendum No. 2** dated **31.01.2025** to **GeM Tender No. GEM/2025/B/5833797** for "*Hiring the services for replacement of existing electrical wiring system in D+, DZ, DD & D-type bungalow.*" is issued to amend the following:

**(i)** SOQ, Make list & Bungalow tentative drawings are enclosed as **ANNEXURE-A, ANNEXURE-B & ANNEXURE-C** respectively.

**(ii)** To read the UOM against Line-Item No. 110 and 120 of the Price Bidding Format as '**Cubic Metres**' in lieu of the existing. Amended Price Bidding Format is also enclosed herewith for reference.

**(iii)** All other terms and conditions of the Bid Document remain unchanged. Details can be viewed at [www.oil-india.com](http://www.oil-india.com).

*Shruti Taye.*

**SR. OFFICER - CONTRACTS (S)**

## SoQ for hiring the services for replacement of existing electrical wiring system in D+, DZ, DD &amp; D-type bungalows

Item No	Item	Short Description	Unit	Total Quantity
<b>Wiring and cabling</b>				
10	Point wiring	Wiring for light point/ fan point/ exhaust fan point/ call bell point with 3 nos Single core 1.5 sq.mm size FRLS PVC insulated multi-stranded copper cable in recess using medium grade ISI approved 25 mm size PVC casing capping & accessories, suitable PVC junction box as required. (Colour codes - Phase -R/Y/B; Neutral -Black & Earth- Green).	No.	3520
20	Light plug point wiring	Wiring for light plug point with 3 nos Single core 1.5 sq.mm size FRLS PVC insulated multi-stranded copper cable in recess using medium grade ISI approved 25 mm size PVC casing capping & accessories etc. as required. (Colour codes - Phase -R/Y/B; Neutral -Black & Earth- Green).	meter	15000
30	Circuit wiring	Wiring for circuit from MCB DB to desired Switch Board with 3 nos Single core 2.5 sq.mm size FRLS PVC insulated multi-stranded copper cable in recess using medium grade ISI approved 25 mm size PVC casing capping & accessories, (Colour codes: Phase -R/Y/B; Neutral -Black & Earth- Green).	meter	19000
40	Power wiring	Wiring for circuit/ Power wiring from MCB DB to desired Switch Board/power point with 3 nos. Single core 4 sq.mm size FRLS PVC insulated multi-stranded copper cable in recess using medium grade ISI approved 25 mm size PVC casing capping & accessories, (Colour codes : Phase -R/Y/B; Neutral -Black & Earth- Green).	meter	16000
50	Wiring for drawing sub main line	Circuit Wiring with 6x10.0 sq mm PVC wire PVC wire in PVC casing capping Wiring for circuit/ sub main wiring from Main panel to TPN DB/VTN DB, DB to MCB DB with 6 nos Single core 10 sq.mm size FRLS PVC insulated copper cable in recess using medium grade ISI approved 32mm size PVC casing capping & accessories, ( Colour codes: Phases - R/Y/B; Neutral -Black & 2 Nos Earth- Green)).	meter	2800
60	Supply of 4 x 10 mmsq PVCA Cable	Cable, 4C x 10 sqmm, 1100V, PVCA Alu. Color: Black Conductor Material: Stranded compact circular/shaped Aluminum Shape: Complete round on outer side Insulation: PVC, Type A Filler & Inner Sheath: Unvulcanized rubber/ Thermoplastic materials/ Proofed tape (for inner sheath only). Outer Sheath: PVC, Type ST 1 Armour: Galvanized Steel strip/Wire Applicable Standard: IS-1554 (part-1)-1988 (with latest amendments if any) Marking: a) Manufacture's name, voltage grade, sequential length (in meters), size of cable, year of manufacture and the letters 'ELECTRIC' shall be printed, indented or embossed on the sheath of the cable throughout the length. The distance between any two consecutive printings, indentations or embossing shall be not more than 1 m.	meter	5400
70	6 SWG GI Wire as catenary	Size : 0.488 cm. (6 SWG),	meter	3200
80	Supply of 4 x 50 mmsq Cable	Cable, 4C x 50 sqmm, 1100V, PVCA Alu. Voltage Grade: 1100V Color: Black Conductor Material: Stranded compact circular/shaped Aluminum Shape: Complete round on outer side Insulation: PVC, Type A Filler & Inner Sheath: Unvulcanized rubber/ Thermoplastic materials/ Proofed tape (for inner sheath only). Outer Sheath: PVC, Type ST 1 Armour: Galvanized Steel strip/Wire Applicable Standard: IS-1554 (part-1)-1988 (with latest amendments if any) Marking: a) Manufacture's name, voltage grade, sequential length (in meters), size of cable, year of manufacture and the letters 'ELECTRIC' shall be printed, indented or embossed on the sheath of the cable throughout the length. The distance between any two consecutive printings, indentations or embossing shall be not more than 1 m.	meter	3000
90	Supply of 1x 16 mmsq Cable	Cable, 1C x 16 mm <sup>2</sup> , 1100V, PVC Alu. (Earthing) Voltage Grade: 1100V Colour: Black Conductor Material: Stranded compact circular Aluminum Shape: Complete round on outer side Insulation: PVC; Sheath: PVC Applicable Standard: IS-1554 (part-1)-1988 (with latest amendments if any) Marking: a) Manufacture's name, voltage grade, sequential length (in meters), size of cable, year of manufacture and the letters 'Earthing' and 'ELECTRIC' shall be printed, indented or embossed on the sheath of the cable throughout the length. The distance between any two consecutive printings, indentations or embossing shall be not more than 1 m.	meter	2600
100	Supply and fixing of GI guard pipe for cable	Supplying and fixing of light class G.I pipe of 50 mm dia. (nominal) 3 metres length along the pole for protection of under ground cable as required.	No.	460
110	Cutting & Laying of cable in UG Trench upto 35 sqmm	Laying of one number PVC insulated and PVC sheathed/XLPE Sheathed power cable of 1.1 kV grade of size upto 35 sq mm direct in ground including excavation, sand cushioning, protective covering and refilling of trench etc as required	cubic meter	4200
120	Cutting & Laying of cable in UG Trench from 35 sqmm to 95 sq mm	Laying of one number PVC insulated and PVC sheathed/XLPE Sheathed power cable of 1.1 kV grade of size from 35 sqmm to 95 sq mm direct in ground including excavation, sand cushioning, protective covering and refilling of trench etc as required	cubic meter	4000
130	Laying of one number additional PVC insulated and PVC sheathed/XLPE Power cable	Laying of one number additional PVC insulated and PVC sheathed/XLPE Sheathed power cable of 1.1 kV grade of size 35 sqmm to 95 sqmm direct in ground in the same trench in one tier horizontal formation including excavation, and refilling of trench etc as required	meter	2400
140	Laying and fixing cable on wall surface	Laying and fixing of one number PVC insulated and PVC Sheathed/XLPE Power cable of 1.1 kV grade of size upto 35 sqmm (Clamped with 1 mm thick saddle)	meter	3000
<b>DBs MCCBs, Switch boards</b>				
150	S/F MCCB (40A)	40A, 25kA, 4P, thermal magnetic protection MCCB, Ics=100%Icu, thermal adjustable- 0.8 to 1 In, Magnetic setting adjustable - 10In. Metallic enclosure shall be provided for housing the 4 pole MCCB.	No.	60
160	S/F TPN DB (63A,30mA)	3 phase 8 way TPN prewired MCB DB with double door of following specification: DB shall be as per IS 8623, Suitable for Flush mounting and surface mounting application with 100 A copper busbar for each phase, with neutral bar, earth bar and cable ties for cable management, fully insulated busbar and neutral bar. DB shall have proper arrangement for door earthing and corner shields for better protection, Pan assembly for ease of installation, masking sheet, with provision for four pole RCBO as incomer and SP MCB as outgoing, supplied with wire set and MCBs. Wires shall be FRLS copper single core cables of sufficient capacity. DB shall have protection against mechanical impact, minimum protection index shall be IK 09 with acrylic door of IEC-62262 and Ingress protection of IP43. Part 1:DB shall have 63 A,10kA 30 mA RCBO as incomer as per IS: 12460 with latest amendments, Part 2. Outgoing distribution in each phase shall consist of 8 nos. of MCB (4 nos. of 10 A and 4 nos. of 20 A MCB), all C curve, 10 kA capacity; total no. of MCBs in DB- 24 nos. All MCBs shall be as per IS/IEC 60947-2. All accessories like Lugs/Thimble etc .required for installation shall be supplied by Contractor.	No.	80

170	S/F of 8 Module box with base and cover plate	8 Module PVC type Switch Board. Complete with Modular type Frame Plate with matching Cover Plate suitable to accommodate specified number of electrical accessories. Frame Plate shall be made out of polycarbonate. The configurations for the relevant plate are defined as under: A- Number of Rows: 1 B- Number of openings: 8 C- Size of opening.1M Internal connection of wire is included in the item.	No.	440
180	S/F of 4 Module box with base and cover plate	4 Module PVC type Switch Board. Complete with Modular type Frame Plate with matching Cover Plate suitable to accommodate specified number of electrical accessories. Frame Plate shall be made out of polycarbonate. The configurations for the relevant plate are defined as under: A- Number of Rows: 1 B- Number of openings: 4 C- Size of opening.1M Internal connection of wire is included in the item.	No.	160
190	S/F of 3 Module box with base and cover plate	3 Module type PVC Switch Board. Complete with Modular type Frame Plate with matching Cover Plate suitable to accommodate specified number of electrical accessories. Frame Plate shall be made out of polycarbonate. The configurations for the relevant plate are defined as under: A- Number of Rows: 1 B- Number of openings: 3 C- Size of opening.1M Internal connection of wire is included in the item.	No.	840
200	S/F of 2 Module box with base and cover plate	2 Module type PVC Switch Board. Complete with Modular type Frame Plate with matching Cover Plate suitable to accommodate specified number of electrical accessories. Frame Plate shall be made out of polycarbonate. The configurations for the relevant plate are defined as under: A- Number of Rows: 1 B- Number of openings: 2 C- Size of opening.1M Internal connection of wire is included in the item.	No.	80
210	S/F of 6 Way VTPN DB	Supply,Installation,Testing & commissioning 160 A, 6W, VTPN MCCB DB Supply of 3 Phase, 6 WAY, vertical TPN MCCB DB, as per the following specifications: A. Incoming: a. 160 A Thermal adjustable MCCB: 1 no b. Rating: 4 pole, 160 A, 25kA, 50Hz, 415VAC c. Protection: Thermal and Magnetic Protection B. Outgoing Feeders: a. 63 A TP C curve MCB: 6nos b. All outgoing MCBs shall be 'C' curve, 240v AC, 10kA breaking capacity, with DMC housing, suitable for class-II tropicalisation (as per IEC) & approved by ISI or IEC. MCBs shall have integrated label holder, biconnect upper & lower terminals & air channels for low temperature rise. C. Bus bar: 250 A, Tinned Copper D. Constructional details of DB: DB shall be as per IS-8623 with latest amendment. DB shall have external earth terminal & mounting holes. Cable ties & wire leads for wiring incomer MCCB to respective phase & neutral buses shall be done with suitable spreader links. Supplied and wired with single core 35 sqmm stranded copper cable with tinned copper lugs. Enclosure shall be IP-43& IK-09 with double door. DB shall have detachable cable entry gland plate on top and bottom side for keeping spare length of cables. All wires inside DB shall have ferrules for identification of circuit number. All unused openings shall be fitted with Blanking Plates. The DB shall be provided with 250 amp tinned copper bus bar for phase & neutral. Neutral & Earth bar shall be 8 way each & suitable for termination of wires with pin type cable lugs. All accessories like Gland/Lugs/Thimble etc .required for installation shall be supplied by Contractor.	no.	20
220	S/F of Junction Box for MCB DB (150 mm X 150 mm X 60 mm)	Supplying and fixing metal box of 150 mm X 150 mm X 60 mm on surface or in recess with suitable size of phenolic laminated sheet cover in front including painting etc as required.	No.	560
230	S/F of Junction Box for MCB DB (200 mm X 250 mm X 100 mm)	Supplying and fixing metal box of 200 mm X 250 mm X 100 mm on surface or in recess with suitable size of phenolic laminated sheet cover in front including painting etc as required.	No.	120
<b>Switch Sockets, Switches</b>				
240	S/F of 3 pin 6 amp socket with switch	Supplying and fixing of 3 pin 5/6 amps modular socket outlet and 5/6 amps modular switch, connection etc. as required. in existing PVC modular box with cover plate. Modular type switch shall be ISI marked, modular, unenclosed, push / piano type suitable for flush mounting with screw type terminals suitable for 250V, 50Hz. supply and conforming to IS: 3854/1997 Reaffirmed 2007. Modular socket outlet, flush type mounting, non-shuttered type for 250V, 50Hz. supply and conforming to IS:1293/2005 with amendments No.1, 2 & 3. The dimensions shall be as per annexure A of IS: 1293/2005 with amendments No.1, 2 & 3. Note:-Dimensions and withdrawal force values for 2-pin sockets and 5-pin sockets shall be as per IS:1293.	No.	2140
250	S/F 25 A RCBO Metal Plug Socket	Supplying and installation of recess type 25A metallic plug/socket DB complete with 25A Plug and Socket and 25 A DP RCBO, 30 mA sensitivity for AC.	No.	220
260	S/F of 5 pin 6/16 amp socket with 16 A Switch	Supplying and fixing 3 module GI box with modular frame plate and cover plate in front on recess, including providing and fixing 6 pin 5/6 & 15/16 amps modular socket outlet and 15/16 amps modular switch, connection etc. as required. Modular type switch shall be ISI marked modular, unenclosed, push / piano type suitable for flush mounting with screw type terminals suitable for 250V, 50Hz. supply and conforming to IS: 3854/1997 Reaffirmed 2007. Modular socket outlet, flush type mounting, non-shuttered type for 250V, 50Hz supply and conforming to IS:1293/2005 with amendments No.1, 2 & 3.The dimensions shall be as per annexure A of IS: 1293/2005 with amendments No.1, 2 & 3. Note: Dimensions and withdrawal force values for 2-pin sockets and 5-pin sockets shall be as per IS:1293.	No.	680
270	S/F of 6 amps switch	Supply and fixing of 6 A Modular switch in the existing modular boxes. Modular type switch shall be ISI marked modular, unenclosed, push / piano type suitable for flush mounting with screw type terminals suitable for 250V, 50Hz. supply and conforming to IS: 3854/1997 Reaffirmed 2007.	No.	3520
280	S/F of call bell/ buzzer	Supply and fixing of call bell/ buzzer suitable for single phase, 230 volts, complete as required and including making necessary connections as required.	No.	80
290	S/F of Bell push	Supply and fixing of 6 A one way modular clip in bell push switch with indicator including making necessary connections as required.	No.	80
<b>Point Wiring</b>				

300	Supply and Fixing bldc Ceiling fan	Supply, Installation, Testing and Commissioning of 1200 mm sweep, BEE 5 star rated ceiling fan with Brush Less Direct Current (BLDC) Motor, class of insulation:B, 3 nos. blades, 2 nos. canopies, copper winding, Power Factor not less than 0.9, , Air delivery minimum 220 Cum/Min, remote or electronic regulator unit for speed control and all remaining accessories including safety pin, nut bolts, washers, suitable for 230 V, 50 Hz, single phase AC supply, earthing etc. complete as required.	No.	380
310	Supply and Fixing Exhaust fan,225 mm	Supply, Installation, testing and commissioning of Exhaust Fan, 225 mm sweep, 900±10% RPM heavy duty metallic exhaust fan in the existing pening, including making the hole to suit the size of the above fan, making good the damage, connection, testing, commissioning etc. as required. Fan shall have pre-lubricated double ball bearing for maintenance free running and conforming to IS 2312-1967 with latest amendment.	No.	80
320	Supply and fixing of 2ft LED batten fitting	Supply, Installation, testing and commissioning of surface mounting powder coated, Aluminum extrusion housing, IP20 acrylic diffuser fitted 2 ft (600 mm) LED batten, LM-79 certified luminaire & LM-80 certified LED chip (SMD) complete with all mounting accessories. The product should have an even light distribution with max.10 +/-10% w system wattage, system lumen greater than 1300 Lumen, system efficacy >100 lm/W, CCT 6500k, CRI >80. THD shall be <10% and PF>0.9. Lifetime shall not be less than 40000 hours.The product should have an Electronic constant current driver with Open & Short circuit protection, reverse polarity protection and surge protection.	No.	760
330	Supply and fixing of 36/40 W 4ft LED batten fitting	Supply, Installation, testing and commissioning of surface mounting powder coated, Aluminum extrusion housing, IP20 acrylic diffuser fitted 4 ft (1200 mm) LED batten, LM-79 certified luminaire & LM-80 certified LED chip (SMD) complete with all mounting accessories. The product should have an even light distribution with max.20 +/-10% w system wattage, system lumen greater than 1800 Lumen, system efficacy >100 lm/W, CCT 6500k, CRI >80. THD shall be <10% and PF >0.9. Life time shall not be less than 40,000 hours.The product should have an electronic constant current driver with open & short circuit protection, reverse polarity protection and surge protection.	No.	1980
340	Supply and Fixing of decorative bracket light	Supply and fixing of Wall Mounted Bracket LED Light with 2 nos. light frosted glass with chrome finish wall lamp inclusive of 2 nos. 7W E27 lamp. Similar to JNL-CHR-MB160275542A of Jaguar make.	No.	500
350	S/F of Suspended type of bracket light	Supply and fixing of suspended LED bracket light with 01 no. clear glass and chrome finish pendent inclusive of 4 W LED lamp. Similar to JNL-CHR-MD160020051C of Jaguar make.	no.	80
360	S/F Ceiling rose with mounting PVC box	Supplying and fixing 3 pin, 5 amp ceiling rose with mounting PVC box	No.	3000
370	S/F Modular blank plate	Supply and fixing of modular Blank Plate matching with modular switch boxes.	No.	2080
<b>Earthing Works</b>				
380	S/F of Earth electrode	Earth electrode, material GI, with the following specifications:  (1) Earth electrode shall be made out of steel tubular pipe 3000 mm long x 100 mm ID, minimum 5 mm pipe wall thickness [as per IS: 1239, (Part-I): 2004]. (2) Each electrode shall have four nos. of 'L' shaped connectors made from 50x6 mm GI strap welded on the top end of electrode for connection purpose. Each side of the connector shall be 150 mm long. The weld shall be complete along the jointing surface. The weld shall be cleaned of slug before galvanisation. Each connector shall have two holes (of dia. 14 mm) suitable for M10 size GI Bolts & Nuts [as per IS:1363 (Part- I)-2019/ISO 4016]. (3) Lower end of the electrode shall have smooth tapered finish over a length of approx. 75 mm. (4) Staggered drilled holes of 12 mm dia. at intervals of 150 mm shall be made on the surface of the electrode before galvanization. Each electrode shall have minimum 20 nos. holes on its surface. (5) Top end of the electrode shall be properly crowned/ capped to restrict entry of unwanted solid objects in the pipe blocking the same. However, suitably sizes hole shall be made on the crown for ease of pouring water in the electrode. (6) The complete electrode after fabrication as above shall be hot dip galvanized conforming to IS: 2629:1985 with latest amendments. Minimum galvanisation thickness shall be 80 microns. (7) Steel tubular Pipe shall be ISI marked, medium grade. Make of GI pipe: TATA/Jindal/ SAIL/Hindustan pipes/NEZONE. Manufacturer's test certificate certifying conformity to IS:1239 for steel pipe as per specifications shall be submitted along with the delivery of the item	No.	80
390	GI Strip of 25x5 mm	EARTH STRAP, G. I., 3 mm x 25 mm Strap, Galvanized Iron, length 5000 mm X Width 25 mm X Thickness 3 mm, Zinc coating: Min. 85 Micron thick, Galvanization must offer protection against corrosion in moist and, environment and against Oilfield chemicals. Test certificate issued by Govt. approved houses/ laboratories showing thickness of Zinc coating should accompany the quotation.	meter	3400
<b>Miscellaneous</b>				
400	Dismantling of old items	Dismantling of all type of Tube light(18 W/ 36 W)/Ceiling fan/Exhaust Fan/CFL/Wiring(Batten)/Casing capping/Conceal wiring)/Main Switch/MCB DB/Swith Board/Call bell etc.	no.	80
<b>Telephone</b>				
410	Supply & laying 5 pair Telephone cable	Supply and laying of 5 pair Telephone cable:P.V.C. insulated, unarmored, 5 pair telephone cable of nominal diameter 0.5 mm each core conforming to S/WS/113-C ITD specifications. Cables shall be used for all wiring from the distribution boards to the termination boards and shall be laid in flat channels described in item no 450.Cables shall be laid from the common junction box of each bungalow/block to the termination boards of the rooms and shall be pulled through the flat channels. No joint shall be allowed in the wiring. The three telephone points shall be connected to operate in parallel and shall be done as per drawing approved by OIL	Meter	3500
420	Supply & laying of PVC Casing Capping	Supply and laying of PVC Flat Casing Capping of size 25mm:All flat channels (casing capping) should be of PVC 25mm wide, Presto/ AKG/Plaza brand and to be approved by OIL (Field Comm.)prior to the start of the installation. Accessories like couplers, bends etc are part of the channels & no separate payment will be made for the accessories. All miscellaneous items for channel work, not specifically mentioned are part of wiring and channel laying and no separate payment shall be made for the same. The laying of the flat channels shall be done to provide telephone points in Four rooms in D+ and Three rooms in DZ and D Type bungalows – one in the living room and rest in the bed rooms. The laying of flat channels shall be done in accordance with drawings. The contractor shall prepare detailed layout drawing showing channels, termination boxes etc., and obtain Engineer-in-charge (Field Communication) approval before carrying out work on site. Channels shall be fixed on the walls by fixing wooden/PVC gutka and SS screws at interval of 20cm. The laying should not be carried along electrical circuit wiring	meter	3100
430	Supply and fixing of Termination Boards	Supply and fixing of Termination Boards with two numbers of RJ-11 telephone outlet socket in each board:PVC telephone termination board of size 10cm X 10cm X 4.5cm with Two nos. of RJ-11 telephone outlet socket in each board, Presto/AKG/Plaza brand and to be approved by engineer-in-charge (Field Communication) prior to the start of the installation. Termination boards shall be fitted on the walls of living room and bed rooms at the end points of PVC flat channels preferably near AC power switch sockets	No.	160

## APPROVED MAKE LIST

SL. NO.:	DESCRIPTION OF ITEM	APPROVED MAKES
1	SINGLE CORE BIS MARKED, COPPER, FRLSH PVC INSULATED MULTISTRANDED 1100V GRADE CABLE/WIRE	FINOLEX/HAVELLS/POLYCAB/RR KABEL/KEI
2	ALL MULTI CORE PVC ALUMINIUM CABLE	FINOLEX/HAVELLS/POLYCAB/RR KABEL/KEI
3	EARTH WIRE	FINOLEX/HAVELLS/POLYCAB/RR KABEL/KEI
4	LUGS	DOWELL/3D-BILLET/JAINEX/SCHNEIDER
5	PVC CASING CAPPING	PRESTO PLAST/AKG/PLAZA/ WELKM /PRESTO TEAK
6	PVC CASING BOX	ANCHOR/LEGRAND/ WELKM /PRESTOPLAST
7	PVC CONDUIT	RICHA/ ANCHOR /PLAZA/AKG/ PRESTOPLAST/ WELKM
8	PVC BOARD	PRESTO PLAST/AKG/PLAZA/WELKM/PRESTO TEAK
9	20 A METAL CLAD SWITCH-SOCKET UNIT	LEGRAND/SCHNEIDER/SIEMENS/HAVELLS/ABB/L&T
10	EXHAUSTFAN, PEDESTAL FAN , CEILING FAN ETC.	HAVELLS/BAJAJ/ORIENT/USHA/CROMPTON GREAVES
11	LIGHT FITTINGS (INCLUDING DRIVER)	PHILIPS/CROMPTON/BAJAJ/HAVELLS/WIPRO
12	MCCB	LEGRAND/SCHNEIDER/SIEMENS/HAVELLS/ABB/L&T
13	MCB	LEGRAND/SCHNEIDER/SIEMENS/HAVELLS/ABB/L&T
14	RCBO	LEGRAND/SCHNEIDER/SIEMENS/HAVELLS/ABB/L&T NOTE: RCBO, MCBS AND BOX SHALL BE OF SAME MAKE
15	MCB DB	LEGRAND/SCHNEIDER/SIEMENS/HAVELLS/ABB/L&T NOTE: MCB DB AND MCBS/RCBO FITTED THEREIN HAVE TO BE OF SAME MAKE
16	VTPN DB	LEGRAND/SCHNEIDER/SIEMENS/HAVELLS/ABB/L&T NOTE: VTPN DB AND ALL COMPONENTS FITTED THEREIN HAVE TO BE OF SAME MAKE
17	TPN DB	LEGRAND/SCHNEIDER/SIEMENS/HAVELLS/ABB/A&B/L&T NOTE: TPN DB AND ALL COMPONENTS FITTED THEREIN HAVE TO BE OF SAME MAKE
18	MODULAR SWITCHES/SOCKETS/BOX	LEGRAND/SCHNEIDER/CRABTREE/INDOASIAN ELVIRA/HAVELLS
19	METAL ENCLOSURE FOR MCB/MCCB	LEGRAND/SCHNEIDER/SIEMENS/HAVELLS/ABB/L&T

20	CABLE GLAND	DOWELL/ GLAND MAKE/JAINSON/BALIGA/3D
----	-------------	--------------------------------------

Note 1: Contractor should strictly adhere to the approved make list. In case of urgency, operational exigencies, difficulty in procuring or obsolescence, other equivalent makes may be approved. Such equivalents, however, may be used only with the prior approval of concerned engineer -in-charge of OIL.

Note 2: Certain items shall be installed as one integral unit, as per specification in SoQ (like MCB, RCBO and MCB DB; or MCB and metal box, or VTPN etc. In such cases, the make shall be the same for all items within that integral unit.

Tentative Layout Drawing for D-Type Bungalows

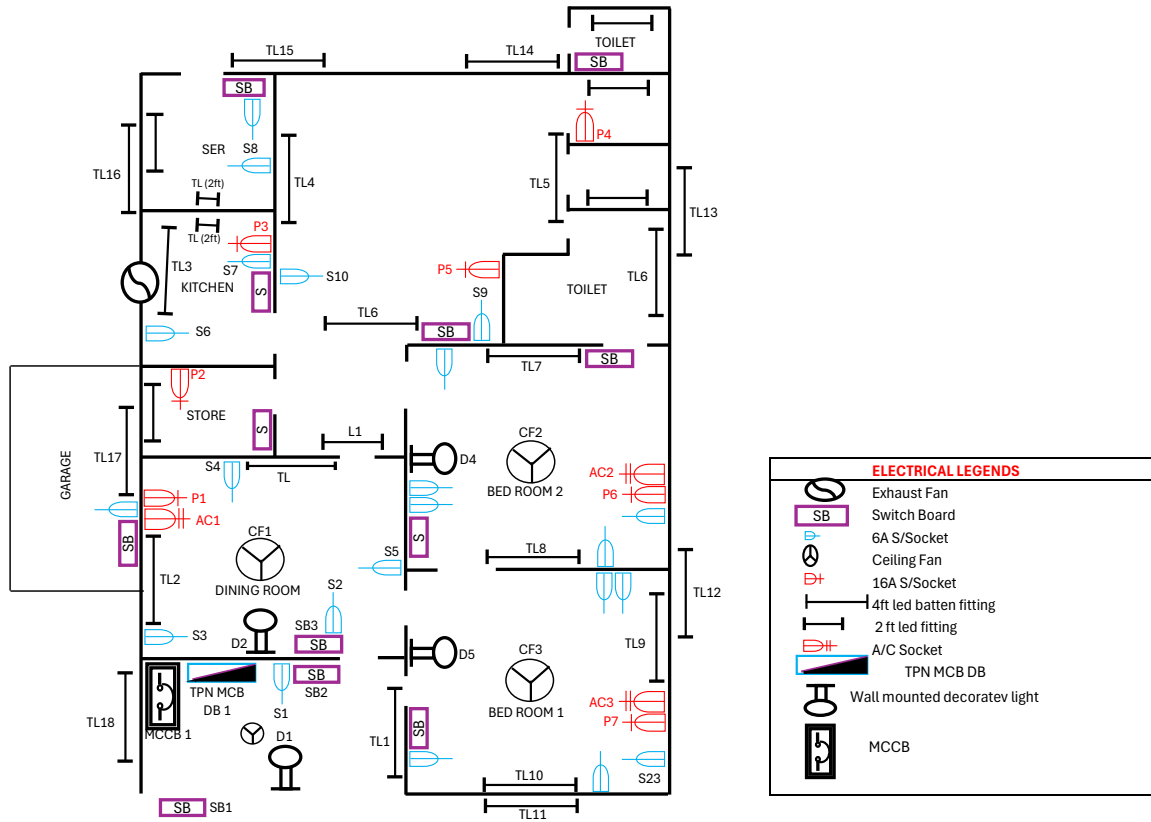

Tentative Layout Drawing for DD-Type Bungalows

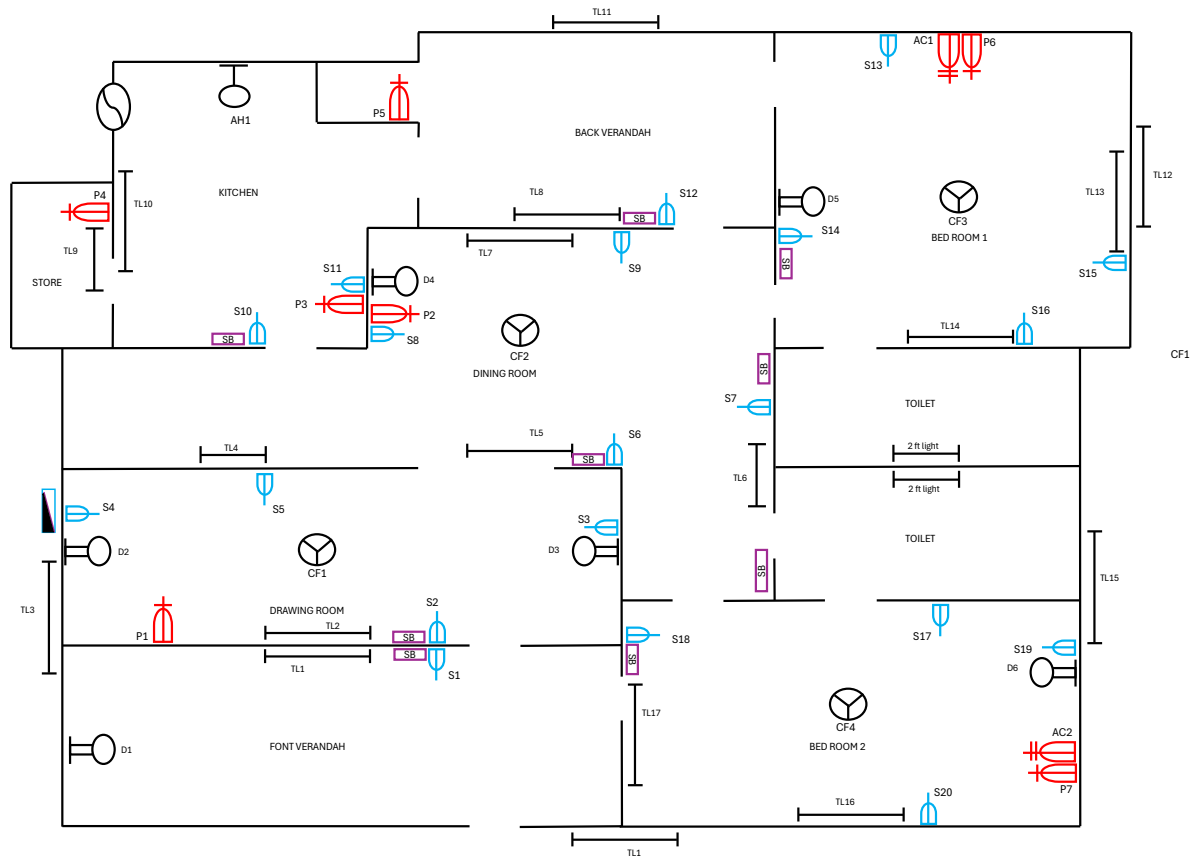

ELECTRICAL LEGENDS	
	Exhaust Fan
	Switch Board
	6A S/Socket
	Ceiling Fan
	16A S/Socket
	4ft led batten fitting
	2 ft led fitting
	A/C Socket
	TPN MCB DB
	Wall mounted decorative light
	MCCB

Tentative Layout Drawing for D+ Jr and D+ Sr-Type Bungalows

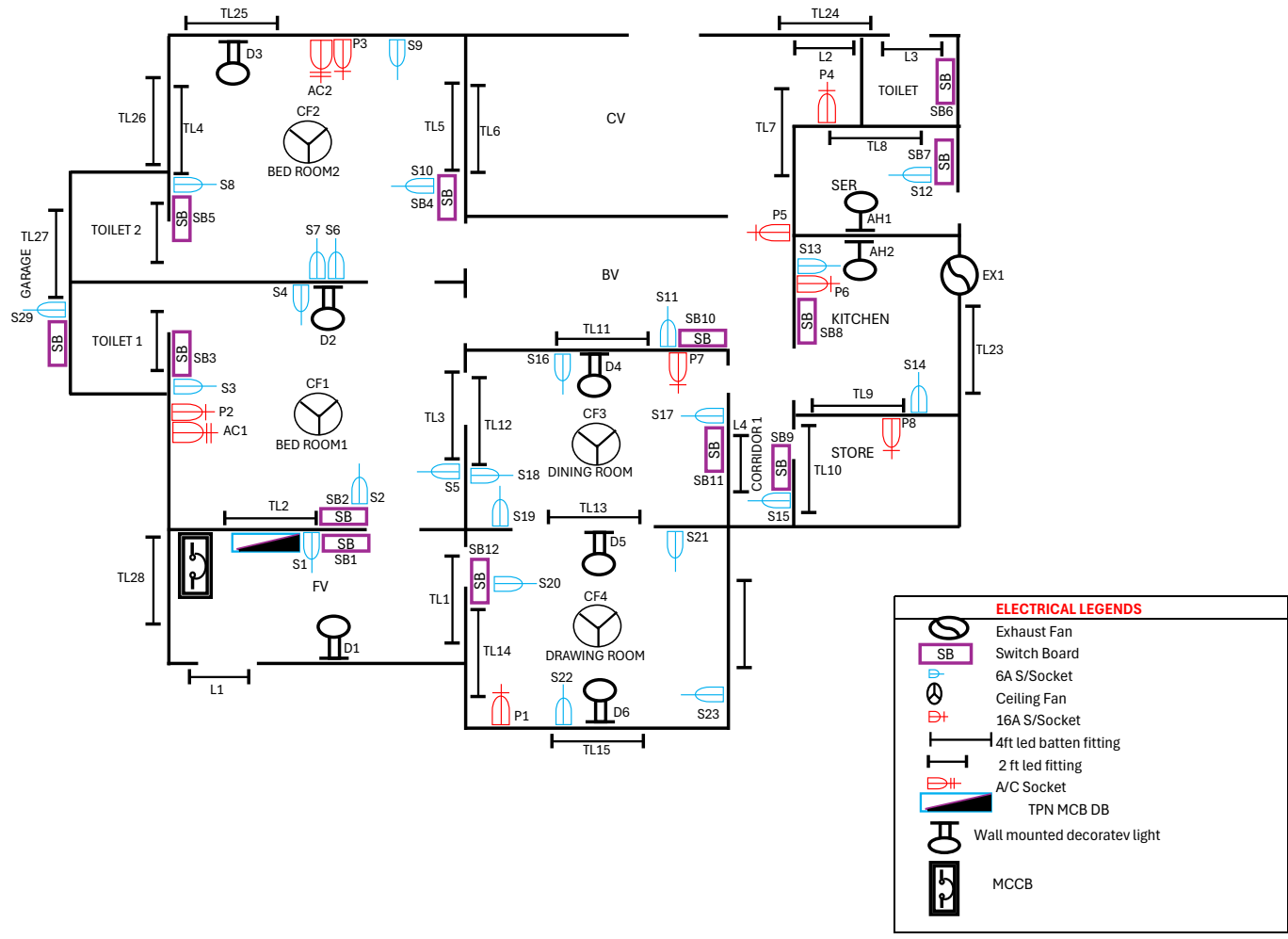

Tentative Layout Drawing for D+ Sr Sr-Type Bungalows

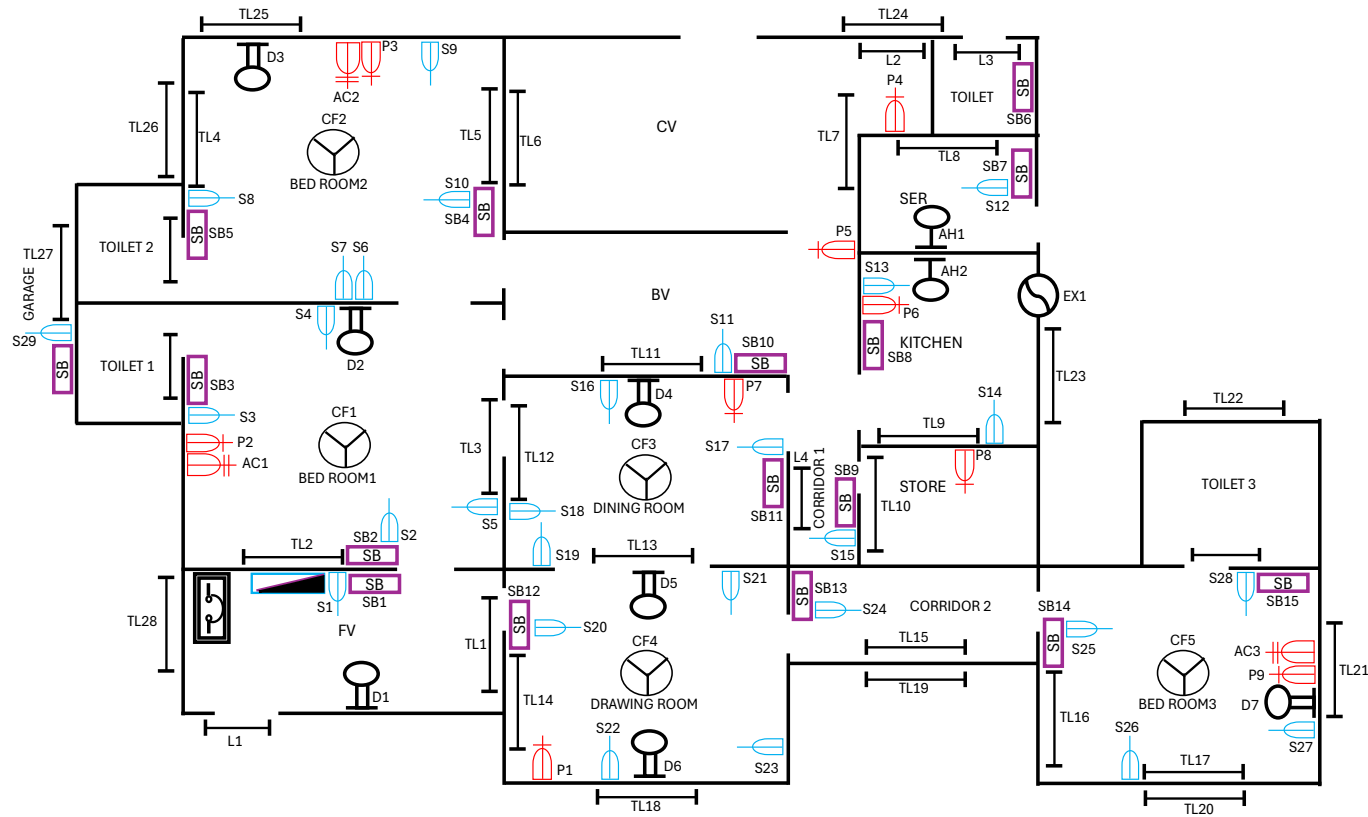

ELECTRICAL LEGENDS	
	Exhaust Fan
	Switch Board
	6A S/Socket
	Ceiling Fan
	16A S/Socket
	4ft led batten fitting
	2 ft led fitting
	A/C Socket
	TPN MCB DB
	Wall mounted decorative light
	MCCB

Tentative Layout Drawing for DZ-Type Bungalows (Ground Floor)

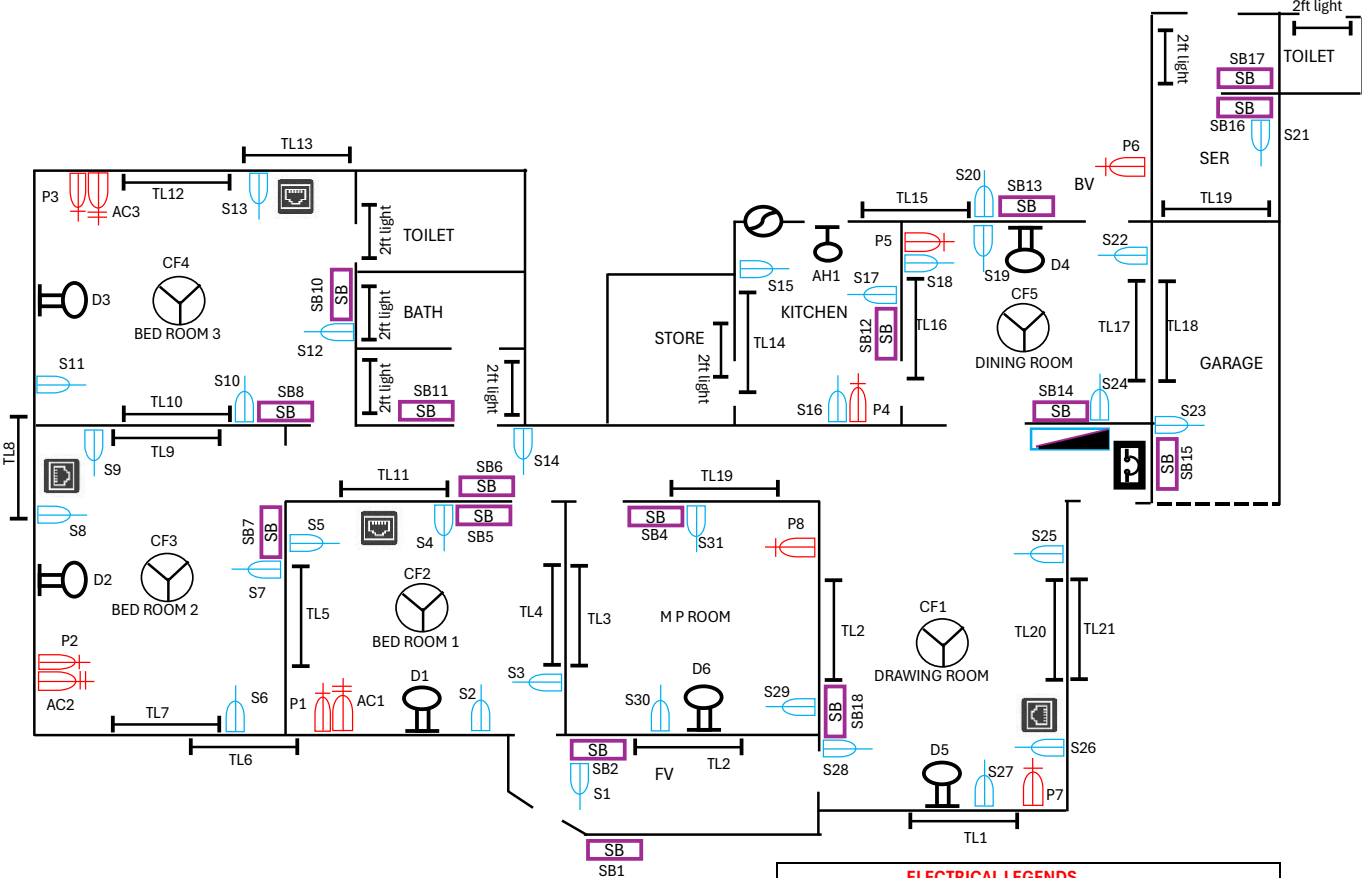

ELECTRICAL LEGENDS	
	Exhaust Fan
	Switch Board
	6A S/Socket
	Ceiling Fan
	16A S/Socket
	4ft led batten fitting
	2 ft led fitting
	A/C Socket
	TPN MCB DB
	Wall mounted decorative light
	MCCB

Tentative Layout Drawing for DZ-Type Bungalows (First Floor)

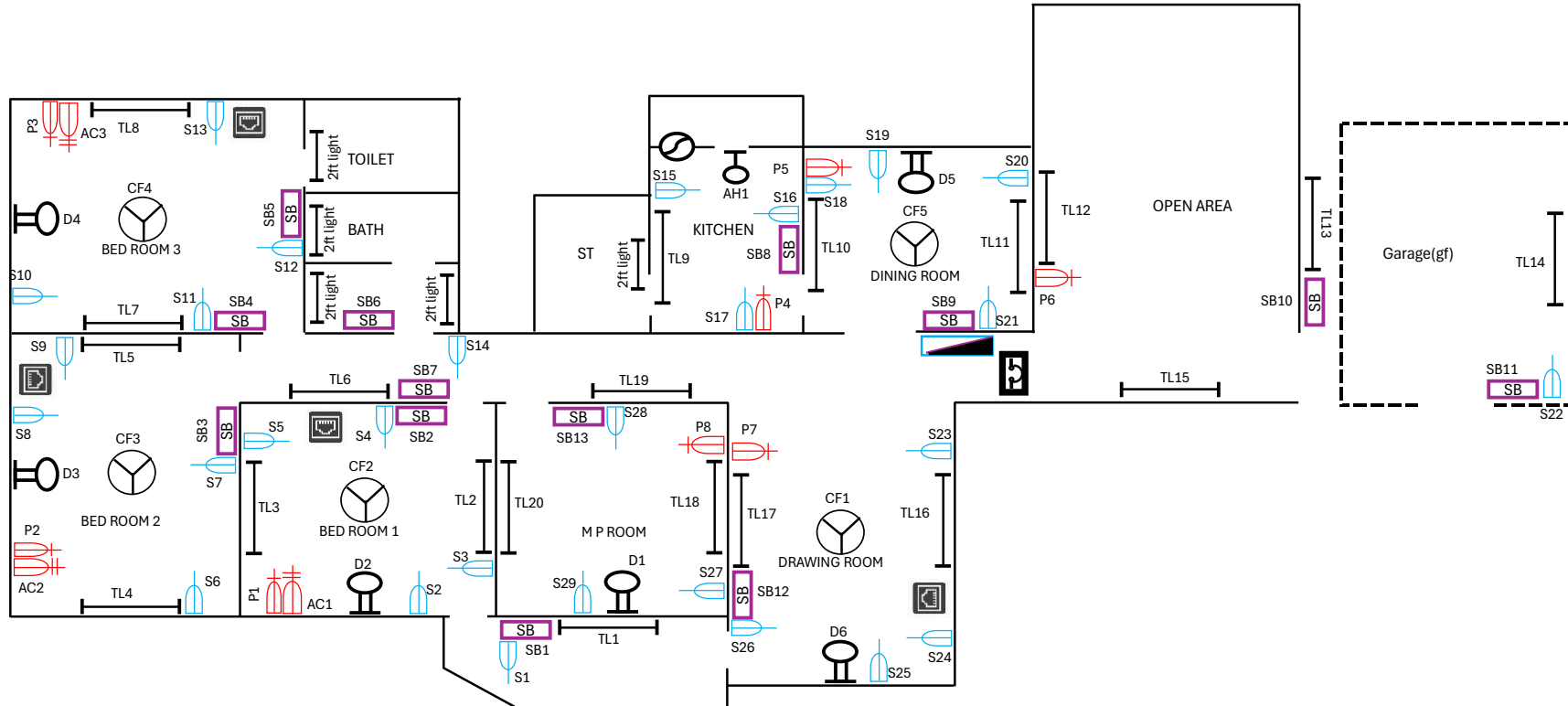

ELECTRICAL LEGENDS	
	Exhaust Fan
	Switch Board
	6A S/Socket
	Ceiling Fan
	16A S/Socket
	4ft led batten fitting
	2 ft led fitting
	A/C Socket
	TPN MCB DB
	Wall mounted decorative light
	MCCB

**OIL INDIA LIMITED**  
**(A Government of India Enterprise)**  
**Duliajan, Assam**

**BOQ/PRICE BIDDING FORMAT**

**Note: The breakup of the quoted/offered price i.e. the duly filled Price Bid Format MUST NOT be uploaded with the technical bid; otherwise the bid shall be rejected straightway.**

**DESCRIPTION OF SERVICES:** Hiring the services for replacement of existing electrical wiring system in D+, DZ, DD & D-type bungalows.

<b>NAME OF BIDDER</b>					
<b>Bidder's GSTIN No.</b>					
<b>SAC Code</b>					
<b>Item No.</b>	<b>Description of Services</b>	<b>UOM</b>	<b>Estimated Quantity</b>	<b>Rate (₹) to be quoted Excluding GST</b>	<b>Amount Excluding GST</b>
			<b>A</b>	<b>B</b>	<b>C = A * B</b>
<b>10</b>	<b>Point wiring</b> Wiring for light point/ fan point/ exhaust fan point/ call bell point with 3 nos Single core 1.5 sq.mm size FRLS PVC insulated multi-stranded copper cable in recess using medium grade ISI approved 25 mm size PVC casing capping & accessories, suitable PVC junction box as required. (Colour codes – Phase –R/Y/B; Neutral –Black & Earth-Green)	NO	3,520	-	₹ -
<b>20</b>	<b>Light plug point wiring</b> Wiring for light plug point with 3 nos Single core 1.5 sq.mm size FRLS PVC insulated multi-stranded copper cable in recess using medium grade ISI approved 25 mm size PVC casing capping & accessories etc. as required. (Colour codes – Phase –R/Y/B; Neutral –Black & Earth-Green)	M	15,000	-	₹ -
<b>30</b>	<b>Circuit wiring</b> Wiring for circuit from MCB DB to desired Switch Board with 3 nos Single core 2.5 sq.mm size FRLS PVC insulated multi-stranded copper cable in recess using medium grade ISI approved 25 mm size PVC casing capping & accessories, (Colour codes: Phase –R/Y/B; Neutral –Black & Earth- Green)	M	19,000	-	₹ -

40	<p><b>Power wiring</b> Wiring for circuit/ Power wiring from MCB DB to desired Switch Board/power point with 3 nos. Single core 4 sq.mm size FRLS PVC insulated multi-stranded copper cable in recess using medium grade ISI approved 25 mm size PVC casing capping &amp; accessories, (Colour codes : Phase -R/Y/B; Neutral -Black &amp; Earth- Green)</p>	M	16,000		₹	-
50	<p><b>Wiring for drawing Submain line</b> Circuit Wiring with 6x10.0 sq mm PVC wire PVC wire in PVC casing capping Wiring for circuit/ sub main wiring from Main panel to TPN DB/VTPN DB, DB to MCB DB with 6 nos Single core 10 sq.mm size FRLS PVC insulated copper cable in recess using medium grade ISI approved 32mm size PVC casing capping &amp; accessories, ( Colour codes: Phases - R/Y/B; Neutral -Black &amp; 2 Nos Earth- Green)</p>	M	2,800		₹	-
60	<p><b>Supply of 4x10 sqmm PVCA cable</b> Cable, 4C x 10 sqmm, 1100V, PVCA Alu. Color: Black Conductor Material: Stranded compact circular/shaped Aluminum Shape: Complete round on outer side Insulation: PVC, Type A Filler &amp; Inner Sheath: Unvulcanized rubber/ Thermoplastic materials/ Proofed tape (for inner sheath only). Outer Sheath: PVC, Type ST 1 Armour: Galvanized Steel strip/Wire Applicable Standard: IS-1554 (part-1)-1988 (with latest amendments if any) Marking: a) Manufacture's name, voltage grade, sequential length (in meters), size of cable, year of manufacture and the letters 'ELECTRIC' shall be printed, indented or embossed on the sheath of the cable</p>	M	5,400		₹	-
70	<p>6 SWG GI wire as catenary Size : 0.488 cm. (6 SWG)</p>	M	3,200		₹	-
80	<p>Supply of 4x50 sqmm cable Cable, 4C x 50 sqmm, 1100V, PVCA Alu. Voltage Grade: 1100V Color: Black Conductor Material: Stranded compact circular/shaped Aluminum Shape: Complete round on outer side Insulation: PVC, Type A Filler &amp; Inner Sheath: Unvulcanized rubber/ Thermoplastic materials/ Proofed tape (for inner sheath only). Outer Sheath: PVC, Type ST 1 Armour: Galvanized Steel strip/Wire Applicable Standard: IS-1554 (part-1)-1988 (with latest amendments if any) Marking: a) Manufacture's name, voltage grade, sequential length (in meters), size of cable, year of manufacture and the letters 'ELECTRIC'</p>	M	3,000		₹	-

<b>90</b>	Supply of 1x16 sqmm cable 1C x 16 mm <sup>2</sup> , 1100V, PVC Alu. (Earthing) Voltage Grade: 1100V Colour: Black Conductor Material: Stranded compact circular Aluminum Shape: Complete round on outer side Insulation: PVC; Sheath: PVC Applicable Standard: IS-1554 (part-1)-1988 (with latest amendments if any) Marking: a) Manufacture's name, voltage grade, sequential length (in meters), size of cable, year of manufacture and the letters 'Earthing' and 'ELECTRIC' shall be printed, indented or embossed on the sheath of the cable throughout the length. The distance between any two consecutive printings, indentations or embossing shall be not more than 1 m.	Cable, M	2,600		₹	-
<b>100</b>	S/F of 50mm dia GI pipe Supplying and fixing of light class G.I pipe of 50 mm dia. (nominal) 3 metres length along the pole for protection of under ground cable as required.	NO	460		₹	-
<b>110</b>	Cutting and laying cable upto 35sqmm Laying of one number PVC insulated and PVC sheathed/XLPE Sheathed power cable of 1.1 kV grade of size upto 35 sq mm direct in ground including excavation, sand cushioning, protective covering and refiling of trench etc as required	Cubic Metre	4,200		₹	-
<b>120</b>	Cutting and laying cable from 35-95 sqmm Laying of one number PVC insulated and PVC sheathed/XLPE Sheathed power cable of 1.1 kV grade of size from 35 sqmm to 95 sq mm direct in ground including excavation, sand cushioning, protective covering and refiling of trench etc as required	Cubic Metre	4,000		₹	-
<b>130</b>	Laying of additional cable Laying of one number additional PVC insulated and PVC sheathed/XLPE Sheathed power cable of 1.1 kV grade of size 35 sqmm to 95 sqmm direct in ground in the same trench in one tier horizontal formation including excavation, and refiling of trench etc as required	M	2,400		₹	-
<b>140</b>	Laying & fixing cable on wall and fixing of one number PVC insulated and PVC Sheathed/XLPE Power cable of 1.1 kV grade of size upto 35 sqmm (Clamped with 1 mm thick saddle)	Laying M	3,000		₹	-
<b>150</b>	S/F MCCB(40A) 40A, 25kA, 4P, thermal magnetic protection MCCB, Ics=100%Icu, thermal adjustable- 0.8 to 1 In, Magnetic setting adjustable - 10In. Metallic enclosure shall be provided for housing the 4 pole MCCB.	NO	60		₹	-

160	<p>S/F of TPN DB (63A, 30mA)  3 phase 8 way TPN prewired MCB DB with double door of following specification: DB shall be as per IS 8623, Suitable for Flush mounting and surface mounting application with 100 A copper busbar for each phase, with neutral bar, earth bar and cable ties for cable management, fully insulated busbar and neutral bar. DB shall have proper arrangement for door earthing and corner shields for better protection, Pan assembly for ease of installation, masking sheet, with provision for four pole RCBO as incomer and SP MCB as outgoing, supplied with wire set and MCBs. Wires shall be FRLS copper single core cables of sufficient capacity. DB shall have protection against mechanical impact, minimum protection index shall be IK 09 with acrylic door of IEC-62262 and Ingress protection of IP43.  Part 1:DB shall have 63 A,10kA 30 mA RCBO as incomer as per IS: 12460 with latest ammendments. Part 2. Outgoing distribution in each</p>	NO	80		₹ -
170	<p>S/F of 8M box with base &amp; cover 8  Module PVC type Switch Board. Complete with Modular type Frame Plate with matching Cover Plate suitable to accommodate specified number of electrical accessories. Frame Plate shall be made out of polycarbonate.  The configurations for the relevant plate are defined as under:  A- Number of Rows: 1  B- Number of openings: 8  C- Size of opening.1M  Internal connection of wire is included in the item.</p>	NO	440		₹ -
180	<p>S/F of 4M box with base &amp; cover 4  Module PVC type Switch Board. Complete with Modular type Frame Plate with matching Cover Plate suitable to accommodate specified number of electrical accessories. Frame Plate shall be made out of polycarbonate.  The configurations for the relevant plate are defined as under:  A- Number of Rows: 1  B- Number of openings: 4  C- Size of opening.1M  Internal connection of wire is included in the item.</p>	NO	160		₹ -
190	<p>S/F of 3M box with base &amp; cover 3  Module type PVC Switch Board. Complete with Modular type Frame Plate with matching Cover Plate suitable to accommodate specified number of electrical accessories. Frame Plate shall be made out of polycarbonate.  The configurations for the relevant plate are defined as under:  A- Number of Rows: 1  B- Number of openings: 3  C- Size of opening.1M  Internal connection of wire is included in the item.</p>	NO	840		₹ -

200	<p>S/F of 2M box with base &amp; cover  Module type PVC Switch Board. Complete with Modular type Frame Plate with matching Cover Plate suitable to accommodate specified number of electrical accessories. Frame Plate shall be made out of polycarbonate.  The configurations for the relevant plate are defined as under:  A- Number of Rows: 1  B- Number of openings: 2  C- Size of opening.1M  Internal connection of wire is included in the item.</p>	2	NO	80	₹ -
210	<p>S/F of 6 way VTPN DB  Supply,Installation,Testing &amp; commissioning 160 A, 6W, VTPN MCCB DB  Supply of 3 Phase, 6 WAY, vertical TPN MCCB DB, as per the following specifications:  A. Incoming:  a. 160 A Thermal adjustable MCCB: 1 no  b. Rating: 4 pole, 160 A, 25kA, 50Hz, 415VAC  c. Protection: Thermal and Magnetic Protection  B. Outgoing Feeders:  a. 63 A TP C curve MCB: 6nos  c. All outgoing MCBs shall be 'C' curve, 240v AC, 10kA breaking capacity, with DMC housing, suitable for class-II tropicalisation (as per IEC) &amp; approved by ISI or IEC. MCBs shall have integrated label holder, biconnect upper &amp; lower terminals &amp; air channels for low temperature rise.  C. Bus bar: 250 A, Tinned Copper  D. Constructional details of DB:  DB shall be as per IS-8623 with latest amendment. DB shall have external earth terminal &amp; mounting holes. Cable ties &amp; wire leads for wiring incomer MCCB to respective phase &amp; neutral buses shall be done with suitable spreader links. Supplied and wired with single core 35 sqmm stranded copper cable with tinned copper lugs. Enclosure shall be IP-43&amp; IK-09 with double door. DB shall have detachable cable entry gland plate on top and bottom side for keeping spare length of cables. All wires inside DB shall have ferrules for identification of circuit number. All unused openings shall be fitted with Blanking Plates. The DB shall be provided with 250 amp tinned copper bus bar for phase &amp; neutral. Neutral &amp; Earth bar shall be 8 way each &amp; suitable for termination of wires with pin type cable lugs.</p>		NO	20	₹ -
220	<p>S/F of JB (150x150x60)  Supplying and fixing metal box of 150 mm X 150 mm X 60 mm on surface or in recess with suitable size of phenolic laminated sheet cover in front including painting etc as required.</p>		NO	560	₹ -
230	<p>S/F of JB (200x250x100)  Supplying and fixing metal box of 200 mm X 250 mm X 100 mm on surface or in recess with suitable size of phenolic laminated sheet cover in front including painting etc as required.</p>		NO	120	₹ -
240	<p>S/F of 3 pin 6A switch socket  Supplying and fixing of 3 pin 5/6 amps modular socket outlet and 5/6 amps modular switch, connection etc. as required. in existing PVC modular box with cover plate. Modular type switch shall be ISI marked, modular, unenclosed, push / piano type suitable for flush mounting with screw type terminals suitable for 250V, 50Hz. supply and conforming to IS: 3854/1997 Reaffirmed 2007. Modular socket outlet, flush type mounting, non-shuttered type for 250V, 50Hz. supply and conforming to IS:1293/ 2005 with amendments No.1, 2 &amp; 3. The dimensions shall be as per annexure A of IS: 1293/2005 with amendments No.1, 2 &amp; 3. Note:-Dimensions and withdrawal force values for 2-pin sockets and 5-pin sockets shall be as per IS:1293.</p>		NO	2,140	₹ -

<b>250</b>	S/F of 25A RCBO metal plug socket Supplying and installation of recess type 25A metallic plug/socket DB complete with 25A Plug and Socket and 25 A DP RCBO, 30 mA sensitivity for AC.	NO	220		₹	-
<b>260</b>	S/F of 5pin 6/16 switch socket Supplying and fixing 3 module GI box with modular frame plate and cover plate in front on recess, including providing and fixing 6 pin 5/6 & 15/16 amps modular socket outlet and 15/16 amps modular switch, connection etc. as required. Modular type switch shall be ISI marked modular, unenclosed, push / piano type suitable for flush mounting with screw type terminals suitable for 250V, 50Hz. supply and conforming to IS: 3854/1997 Reaffirmed 2007. Modular socket outlet, flush type mounting, non-shuttered type for 250V, 50Hz supply and conforming to IS:1293/ 2005 with amendments No.1, 2 & 3.The dimensions shall be as per annexure A of IS: 1293/2005 with amendments No.1, 2 & 3. Note: Dimensions and withdrawal force values for 2-pin sockets and 5-pin sockets shall be as per IS:1293.	NO	680		₹	-
<b>270</b>	S/F of 6A switch and fixing of 6 A Modular switch in the existing modular boxes. Modular type switch shall be ISI marked modular, unenclosed, push / piano type suitable for flush mounting with screw type terminals suitable for 250V, 50Hz. supply and conforming to IS: 3854/1997 Reaffirmed 2007	NO	3,520		₹	-
<b>280</b>	S/F of call bell/buzzer and fixing of call bell/ buzzer suitable for single phase, 230 volts, complete as required and including making necessary connections as required.	NO	80		₹	-
<b>290</b>	Supply of bell push Supply and fixing of 6 A one way modular clip in bell push switch with indicator including making necessary connections as required.	NO	80		₹	-
<b>300</b>	S/F of ceiling Fan Supply, Installation, Testing and Commissioning of 1200 mm sweep, BEE 5 star rated ceiling fan with Brush Less Direct Current (BLDC) Motor, class of insulation:B, 3 nos. blades, 2 nos. canopies, copper winding, Power Factor not less than 0.9, , Air delivery minimum 220 Cum/Min, remote or electronic regulator unit for speed control and all remaining accessories including safety pin, nut bolts, washers, suitable for 230 V, 50 Hz, single phase AC supply, earthing etc. complete as required.	NO	380		₹	-

<b>310</b>	S/F of Exhaust Fan, 225 mm Supply, Installation, testing and commissioning of Exhaust Fan, 225 mm sweep, 900±10% RPM heavy duty metallic exhaust fan in the existing pening, including making the hole to suit the size of the above fan, making good the damage, connection, testing, commissioning etc. as required. Fan shall have pre-lubricated double ball bearing for maintenance free running and conforming to IS 2312-1967 with latest amendment.	NO	80		₹	-
<b>320</b>	S/F of 2ft batten LED Supply, Installation, testing and commissioning of surface mounting powder coated, Aluminum extrusion housing, IP20 acrylic diffuser fitted 2 ft (600 mm) LED batten, LM-79 certified luminaire & LM-80 certified LED chip (SMD) complete with all mounting accessories. The product should have an even light distribution with max.10 +/-10% w system wattage, system lumen greater than 1300 Lumen, system efficacy >100 lm/W, CCT 6500k, CRI >80. THD shall be <10% and PF>0.9. Lifetime shall not be less than 40000 hours.The product should have an Electronic constant current driver with Open & Short circuit protection, reverse polarity protection and surge protection.	NO	760		₹	-
<b>330</b>	S/F of 36/40W 4ft batten LED Supply, Installation, testing and commissioning of surface mounting powder coated, Aluminum extrusion housing, IP20 acrylic diffuser fitted 4 ft (1200 mm) LED batten, LM-79 certified luminaire & LM-80 certified LED chip (SMD) complete with all mounting accessories. The product should have an even light distribution with max.20 +/-10% w system wattage, system lumen greater than 1800 Lumen, system efficacy >100 lm/W, CCT 6500k, CRI >80. THD shall be <10% and PF >0.9. Life time shall not be less than 40,000 hours.The product should have an electronic constant current driver with open & short circuit protection, reverse polarity protection and surge protection.	NO	1,980		₹	-
<b>340</b>	S/F of decorative bracket light Supply and fixing of Wall Mounted Bracket LED Light with 2 nos. light frosted glass with chrome finish wall lamp inclusive of 2 nos. 7W E27 lamp. Similar to JNL-CHR-MB160275542A of Jaguar make.	NO	500		₹	-
<b>350</b>	S/F suspended bracket light Supply and fixing of suspended LED bracket light with 01 no. clear glass and chrome finish pendent inclusive of 4 W LED lamp. Similar to JNL-CHR-MD160020051C of Jaguar make.	NO	80		₹	-
<b>360</b>	S/F of ceiling rose with pvc box Supplying and fixing 3 pin, 5 amp ceiling rose with mounting PVC box	NO	3,000		₹	-
<b>370</b>	S/F of modular blank plate Supply and fixing of modular Blank Plate matching with modular switch boxes.	NO	2,080		₹	-

380	<p>S/F of earth electrode material GI, with the following specifications:</p> <p style="text-align: right;">Earth electrode,</p> <p>(1) Earth electrode shall be made out of steel tubular pipe 3000 mm long x 100 mm ID, minimum 5 mm pipe wall thickness [as per IS: 1239, (Part-I): 2004].  (2) Each electrode shall have four nos. of 'L' shaped connectors made from 50x6 mm GI strap welded on the top end of electrode for connection purpose. Each side of the connector shall be 150 mm long. The weld shall be complete along the jointing surface. The weld shall be cleaned of slug before galvanisation. Each connector shall have two holes (of dia. 14 mm) suitable for M10 size GI Bolts &amp; Nuts [as per IS:1363 (Part- 1):2019/ISO 4016].  (3) Lower end of the electrode shall have smooth tapered finish over a length of approx. 75 mm.  (4) Staggered drilled holes of 12 mm dia. at intervals of 150 mm shall be made on the surface of the electrode before galvanization. Each electrode shall have minimum 20 nos. holes on its surface.  (5) Top end of the electrode shall be properly crowned/ capped to restrict entry of unwanted solid objects in the pipe blocking the same. However, suitably sized hole shall be made on the crown for ease of pouring water in the electrode.  (6) The complete electrode after fabrication as above shall be hot dip galvanized conforming to IS: 2629:1985 with latest amendments. Minimum galvanisation thickness shall be 80 microns.  (7) Steel tubular Pipe shall be ISI marked, medium grade. Make of GI pipe: TATA/Jindal/ SAIL/Hindustan pipes/NEZOME. Manufacturer's test certificate certifying conformity to IS:1239 for steel pipe as per specifications shall be submitted along with the delivery of the item</p>	NO	80		₹ -
390	<p>GI strip of 25x5 mm  EARTH STRAP, G. I., 3 mm x 25 mm  Strap, Galvanized Iron, length 5000 mm X Width 25 mm X Thickness 3 mm, Zinc coating: Min. 85 Micron thick, Galvanization must offer protection against corrosion in moist and, environment and against Oilfield chemicals. Test certificate issued by Govt. approved houses/ laboratories showing thickness of Zinc coating should accompany the quotation.</p>	M	3,400		₹ -
400	<p>Dismantling of old items  Dismantling of all type of Tube light(18 W/ 36 W)/Ceiling fan/Exhaust Fan/CFL/Wiring(Batten/Casing capping/Conceal wiring)/Main Switch/MCB DB/Switch Board/Call bell etc.</p>	NO	80		₹ -
410	<p>Supply &amp; laying 5 pair Telephone cable  Supply and laying of 5 pair Telephone cable:P.V.C. insulated, unarmored, 5 pair telephone cable of nominal diameter 0.5 mm each core conforming to S/WS/113-C ITD specifications. Cables shall be used for all wiring from the distribution boards to the termination boards and shall be laid in flat channels described in item no 450.Cables shall be laid from the common junction box of each bungalow/block to the termination boards of the rooms and shall be pulled through the flat channels. No joint shall be allowed in the wiring. The three telephone points shall be connected to operate in parallel and shall be done as per drawing approved by OIL</p>	M	3,500		₹ -
420	<p>Supply &amp; laying of PVC Casing Capping  Supply and laying of PVC Flat Casing Capping of size 25mm:All flat channels (casing capping) should be of PVC 25mm wide, Presto/ AKG/Plaza brand and to be approved by OIL (Field Comm.)prior to the start of the installation. Accessories like couplers, bends etc are part of the channels &amp; no separate payment will be made for the accessories. All miscellaneous items for channel work, not specifically mentioned are part of wiring and channel laying and no separate payment shall be made for the same.  The laying of the flat channels shall be done to provide telephone points in Four rooms in D+ and Three rooms in DZ and D Type bungalows – one in the living room and rest in the bed rooms. The laying of flat channels shall be done in accordance with drawings. The contractor shall prepare detailed layout drawing showing channels, termination boxes etc., and obtain Engineer-in-charge (Field Communication)</p>	M	3,100		₹ -

430	Supply and fixing of Termination Boards Supply and fixing of Termination Boards with two numbers of RJ-11 telephone outlet socket in each board:PVC telephone termination board of size 10cm X 10cm X 4.5cm with Two nos. of RJ-11 telephone outlet socket in each board, 'Presto'/AKG/Plaza brand and to be approved by engineer-in-charge (Field Communication) prior to the start of the installation. Termination boards shall be fitted on the walls of living room and bed rooms at the end points of PVC flat channels preferably near AC power switch sockets	NO	160		₹ -
<b>TOTAL</b>					<b>#SPILL!</b>
<b>BUYBACK OF OLD ELECTRICAL EQUIPMENT (QUARTER WISE)</b>					
10	D-Type Bungalows	NO	15		₹ -
20	DD-Type Bungalows	NO	10		₹ -
30	DZ-Type Bungalows	NO	20		₹ -
40	D+ Type Bungalows	NO	35		₹ -
<b>BUYBACK TOTAL</b>					<b>#SPILL!</b>
<b>Total Bid Price (exclusive of GST)</b>					<b>#SPILL!</b>
<b>GST Rate in %</b>		<b>GST##</b>		<b>Total Bid Price (inclusive of GST)</b>	<b>#SPILL!</b>
<p>##Please select GST from the dropdown list i.e., <b>CGST + SGST/CGST+UTGST/IGST/NA</b> *Kindly refer to <b>SCC under Section-II of STC</b> of the tender for <b>detailed scope of the service.</b></p>					
<p>1. The price/rate(s) quoted by the Bidders will be inclusive of all taxes except GST (i.e. IGST or CGST and SGST/UTGST as applicable in case of interstate supply or intra state supply respectively and Cess on GST, if applicable) on the final services. However, GST rate (including cess) to be provided in the respective places in the Price Bidding Format.</p>					
<p>2. The inter-se-ranking of the techno-commercially qualified bidders will be determined on overall lowest cost basis (L-1 offer) i.e., considering the Total quoted price inclusive of all liabilities and GST (CGST &amp; SGST / UTGST or IGST) mentioned in the 'OFFER PRICE' field of GeM portal. If there is any difference between the amount mentioned in the above "OFFER FIELD" price of GeM portal and that mentioned in the "Total Bid Price" of Price bidding format, the price quoted in GeM portal shall be considered and the bidder shall rectify the same in the price bid format to match the Total Bid Price with that mentioned in the GeM portal.</p>					
<p>3. OIL will prefer to deal with registered bidder under GST. Therefore, bidders are requested to get themselves registered under GST, if not registered yet. However, in case any unregistered bidder is submitting their bid, their prices will be loaded with applicable GST while evaluation of bid. Where OIL is entitled for input credit of GST, the same will be considered for evaluation of bid as per evaluation methodology of tender document.</p>					
<p>4. Price Bid uploaded without giving any of the details of the taxes (Including rates and amounts) will be considered as inclusive of all taxes including GST. When a bidder mentions taxes as extra without specifying the rates &amp; amount, the offer will be loaded with maximum value towards taxes received against the tender for comparison purposes. If the bidder emerges as lowest bidder after such loading, in the event of order on that bidder, taxes mentioned by OIL on the Purchase Order/Contracts will be binding on the bidder.</p>					
<p>5. Input Tax Credit on GST (Goods &amp; Service Tax) for this service is NOT available to OIL &amp; the bids will be evaluated based on total price including GST.</p>					
<p>6. Kindly refer to SCC and other chapters of the tender document for detailed description, terms and conditions of the service and quote unit rates accordingly against all the items as per Price Bid Format.</p>					
<p>7. The quantities mentioned is purely for evaluation purpose only. However, payment shall be made on actuals.□</p>					