

Tender No. : DID4435L15/L2
Tender Date : 30.07.2014
Bid Closing On : 09.10.2014 at 13:00 hrs.(IST)
Bid Opening On : 09.10.2014 at 13:00 hrs.(IST)

Tender issued to following parties only:

| S/no | V_Code | Vendor Name | City/Country |
|------|--------|---------------------------------|--------------------|
| 1 | 200140 | BINODE ENGINEERING WORKS | TINSUKIA |
| 2 | 200141 | SHARMA & COMPANY, | TINSUKIA |
| 3 | 200144 | TECHNO CRAFT | DULIAJAN |
| 4 | 200289 | SARADA WELDING WORKS | DULIAJAN |
| 5 | 201654 | TECHNO STEEL & CRAFT INDUSTRIES | GUWAHATI |
| 6 | 201899 | SIDDHARTH MACHINERIES PVT LTD | MAKUM |
| 7 | 202145 | SWASTIK ENGINEERING WORKS, | JORHAT |
| 8 | 202261 | COMMERCIAL ENTERPRISES | NAMRUP |
| 9 | 202911 | STEEL & GRIP | CHABUA |
| 10 | 203157 | ES PEE ENGINEERING WORKS | TINSUKIA |
| 11 | 203772 | EASTERN ENGINEERING | TINSUKIA |
| 12 | 204231 | SUDARSHAN STEEL UDYOG (VESSEL) | TINSUKIA |
| 13 | 204232 | HINDUSTHAN PRODUCTS | TINSUKIA - 786 146 |
| 14 | 204599 | TITNEX INDUSTRY & TRADE | DIBRUGARH |
| 15 | 209350 | EASTERN ENGINEERING WORKS | CHABUA |

OIL INDIA LIMITED
(A Govt. of India Enterprise)
P.O. Duliajan-786602, Assam

E-mail:material@oilindia.in, **Fax No.**91-374-2800533

Tender No. & Date : DID4435L15/L2 30.07.2014

Bid Security Amount : INR 0.00 OR USD 0.00
(or equivalent Amount in any currency)

Bidding Type : Single Bid (Composite Bid)

Bid Closing On : 09.10.2014 at 13:00 hrs. (IST)

Bid Opening On : 09.10.2014 at 13:00 hrs. (IST)

Performance Guarantee : Not Applicable

OIL INDIA LIMITED invites Limited tenders for items detailed below:

| Item No./ Mat. Code | Material Description | Quantity | UOM |
|------------------------|---|----------|-----|
| 10 0C000106 | <p><u>SECURITY HUT</u></p> <p>Design, fabrication & supply of Skid mounted Security Hut fitted with two wooden benches & one desk for resting of security personal, one door, windows in three sides.</p> <p><u>ENCLOSED : Annexure A & B. Lay Out Sketch</u></p> <p>SECURITY HUT</p> <p>Scope of Work:</p> <p>Design, fabrication & supply of Skid mounted Security Hut fitted with two wooden benches & one desk for resting of security personal, one door, windows in three sides. The hut shall be robust in structure & transportable so that it can be transferred from one location to other location depending on requirement.</p> <p>GENERAL DESIGN AND CONSTRUCTION:</p> <p>1.1 Main Shell:</p> <p>The main fabrication of the structural framework should be of integral and all welded type to comprise of the bottom frame, overall framework, sloping self-draining roof and desired doors & windows etc. The main corner vertical support posts shall be of 2 inch tubing. All the corner posts shall be suitably welded at the top with a heavy gauge MS plate which should be able to hold steel forged lifting hooks.</p> <p>1.2 Skid:</p> <p>The under structure / base frame of the hut is to be mounted on the skid consisting of 02 (two) nos. of medium beam - ISMB 200 mm x 100 mm hot rolled 'I' section. At the end portion of the 'I' section structure on both the sides, Steel Pipe of size 142 mm NB X 9.5 mm W/Thickness should be inserted & welded properly. Base frame and skid should be</p> | 6 | NO |

Tender No. & Date : DID4435L15/L2

30.07.2014

| Item No./ Mat. Code | Material Description | Quantity | UOM |
|------------------------|---|----------|-----|
| | <p>made in such a way that no foundation is needed for placement of crew hut.</p> <p>1.3 Flooring:</p> <p>The entire flooring of the crew hut shall be of 6 mm thick MS plate, welded lengthwise and breadth wise properly with the base frame of the Skid.</p> <p>1.4 Side End Walls:</p> <p>The exterior cladding of the shell shall be of Vertical corrugated pressed steel as per IS. The Corrugated steel sheet shall be of 3 mm thick and shall be welded to the bottom MS channel frame, corner posts, top frame and roof frame. The corrugated version acts as stiffeners and increase strength to weight ratio and eliminates the use of any other vertical supports. All gaps should be sealed at edges and at seams, bottom sills to prevent ingress of insects, moisture etc.</p> <p>1.5 Roof:</p> <p>The roof shall be of sloping type from the centre towards the walls for efficient drain of rainwater. The roof shall be made of 3 mm thick plain MS steel sheets as per IS and is provided with adequately pressed reinforced sections from inside for additional strength. All the structural steel used shall be of standard quality as per IS specifications and all steel component / section, machine pressed for rigidity to optimize strength to weight ratio.</p> <p>1.6 Weather Shed:</p> <p>All doors & windows opening shall be provided with weather shed. The weather shed shall be made out of 2 mm thick MS sheets as per IS.</p> <p>1.7 Door & Windows:</p> <p>1.7.1 Door: One (1) no. of Door in each hut of size 1800 mm (H) x 900 mm (W). The door shall be open from outside. Door shall have the provision of locking arrangement externally.</p> <p>1.7.2 Windows: Three (3) nos. of Windows in each hut as per dimensions given in the tentative drawing.</p> <p>1.8 Insulation (Inner paneling): 6 mm Thick ply board shall be provided on all side walls, end walls, roof with special weather proof adhesives.</p> <p>1.9 Electrical fittings:</p> <p>i. One 5 Amp socket along with a switch and one point for bulb along with a switch shall be provided in each hut. Necessary electrical wirings for the same shall be provided.</p> <p>ii. Suitable connection for connecting external power source shall be provided at the exterior.</p> <p>iii. Two cabin earth points (on the skid or body, outside) shall be</p> | | |

Tender No. & Date : DID4435L15/L2

30.07.2014

| Item No./ Mat. Code | Material Description | Quantity | UOM |
|------------------------|---|----------|-----|
| | <p>provided for final termination of earth wires</p> <p>1.10 Pretreatment & Painting:</p> <p>The surface preparation for all steel surfaces shall be pre-treated by sand or shot blasting for degreasing and de-rusting followed by one coat of primer and followed by one coat of epoxy paint. The colour of the paint shall be grey.</p> <p>1.11 Suitable sitting arrangement: Bench & desk shall be provided inside the hut as per the drawing.</p> | | |

Standard Notes: (1) **VALIDITY :** Your offer must be valid for 120 days from the date of bid opening. Offer with inadequate validity will be rejected.

(2) The offer should be submitted in Duplicate.

(3) Any sum of money due and payable to the contractor (including Security Deposit refundable to them) under this or any other contract may be appropriated by Oil India Limited and set-off against any claim of Oil India Limited (or such other person or persons contracting through Oil India Limited) for payment of a sum of money arising out of this contract or under any other contract made by the contractor with Oil India Limited (or such other person or persons contracting through Oil India Limited).

(4) In the event you authorize your dealer/stockist/channel partner to quote on your behalf, the dealer/stockist/channel partner while submitting bid should mention on the body of the envelope that they are submitting bid on your behalf.

In the event the dealer/stockist/channel partner do not mention the name of their OEM/principal on the body of the envelope, the offer shall be treated as unsolicited offer and will not be considered for opening.

The dealer/stockist/channel partner should take note of above while submitting bid on behalf of their OEM/principal.

(5) For order with F.O.R. Destination term, 100% payment against despatch documents will not be entertained. In this regards please refer payment terms in ANNEXURE-MM/TENDER/LP/01/06.

(6) To evaluate the inter-se ranking of the offers, Assam Entry Tax on purchase value will be loaded as per prevailing Government of Assam Guidelines as applicable on bid closing date. Bidders may check this with the appropriate authority while submitting their bids.

(7) Bidder must mention page no./nos. in every pages of their offer.

(8) Bidders should submit their bids (preferably in tabular form) explicitly mentioning compliance / non compliance to all the NIT terms and conditions of NIT.

(9) Bidder should clearly mention their name and address on the outside of the envelope containing their offer.

(10) In the event of receipt of only a single offer against the tender within B.C.date, OIL reserves the right to extend the B.C. date as deemed fit by the company. During the extended period, the bidders who have already submitted the bids on or before the original B.C date, shall not be permitted to revise their quotation.

Special Notes : Special Terms & Conditions:

- 1. Bidder to submit drawings with dimensions of the offered hut along with the bid for evaluation. Bid without drawings will be summarily rejected.**
- 2. Bidder shall furnish the details of the materials to be used for fabrication of the huts along with the bid.**
- 3. All the tubular members, angle irons, MS sheets etc. shall be painted with one coat of primer followed by two coats epoxy paints(Grey colour) for providing protection against the rust.**
- 4. P.O & Sl. Nos. of the huts are to be embossed and written by welding on a visible space with date such as on the top of the doors.**
- 5. In case of placement of order, the supplier shall prepare the detail engineering drawing, GAD, etc. of the hut. Drawings shall be sent to OIL for approval within 4 weeks from the receipt of Purchase Order and fabrication of huts shall be started after approval only.**
- 6. Each hut shall be offered for inspection by OIL Engineer on completion of inside lining, painting etc. i.e. before final dispatching.**

TECHNICAL COMPLIANCE CHECK-LIST

| NIT Requirement | Compliance | | Vendors' Deviation/ Remarks |
|---|------------|----|--------------------------------|
| | Yes | No | |
| <p>Scope of work:</p> <p>Design, fabrication & supply of Skid mounted Security Hut fitted with two wooden benches & one desk for resting of security personal, one door, windows in three sides. The hut shall be robust in structure & transportable so that it can be transferred from one location to other location depending on requirement.</p> | | | |
| GENERAL DESIGN AND CONSTRUCTION: | | | |
| <p>1.1 Main Shell:</p> <p>The main fabrication of the structural framework should be of integral and all welded type to comprise of the bottom frame, overall framework, sloping self-draining roof and desired doors & windows etc. The main corner vertical support posts shall be of 2 inch tubing. All the corner posts shall be suitably welded at the top with a heavy gauge MS plate which should be able to hold steel forged lifting hooks.</p> | | | |
| <p>1.2 Skid:</p> <p>The under structure / base frame of the hut is to be mounted on the skid consisting of 02 (two) nos. of medium beam - ISMB 200 mm x 100 mm hot rolled 'I' section. At the end portion of the 'I' section structure on both the sides, Steel Pipe of size 142 mm NB X 9.5 mm W/Thickness should be inserted & welded properly. Base frame and skid should be made in such a way that no foundation is needed for placement of crew hut.</p> | | | |
| <p>1.3 Flooring:</p> <p>The entire flooring of the crew hut shall be of 6 mm thick MS plate, welded lengthwise and breadth wise properly with the base frame of the Skid.</p> | | | |
| <p>1.4 Side End Walls:</p> <p>The exterior cladding of the shell shall be of Vertical corrugated pressed steel as per IS. The Corrugated steel sheet shall be of 3 mm thick and shall be welded to the bottom MS channel frame, corner posts, top frame and roof frame. The corrugated version acts as stiffeners and increase strength to weight ratio and eliminates the use of any other vertical supports. All gaps should be sealed at edges and at seams, bottom sills to prevent ingress of insects, moisture etc.</p> | | | |
| <p>1.5 Roof:</p> <p>The roof shall be of sloping type from the centre towards the walls for efficient drain of rainwater. The roof shall be made of 3 mm thick plain MS steel sheets as per IS and is provided with adequately pressed reinforced sections from inside for additional strength. All the structural steel used shall be of standard quality as per IS specifications and all steel component / section, machine pressed for rigidity to optimize strength to weight ratio.</p> | | | |

| | | | |
|--|--|--|--|
| 1.6 Weather Shed: All doors & windows opening shall be provided with weather shed. The weather shed shall be made out of 2 mm thick MS sheets as per IS. | | | |
| 1.7 Door & Windows: 1.7.1 Door: One (1) no. of Door in each hut of size 1800 mm (H) x 900 mm (W). The door shall be open from outside. Door shall have the provision of locking arrangement externally | | | |
| 1.7.2 Windows: Three (3) nos. of Windows in each hut as per dimensions given in the tentative drawing. | | | |
| 1.8 Insulation (Inner paneling): 6 mm Thick ply board shall be provided on all side walls, end walls, roof with special weather proof adhesives. | | | |
| 1.9 Electrical fittings: i. One 5 Amp socket along with a switch and one point for bulb along with a switch shall be provided in each hut. Necessary electrical wirings for the same shall be provided. | | | |
| ii. Suitable connection for connecting external power source shall be provided at the exterior. | | | |
| iii. Two cabin earth points (on the skid or body, outside) shall be provided for final termination of earth wires. | | | |
| 1.10 Pretreatment & Painting: The surface preparation for all steel surfaces shall be pre-treated by sand or shot blasting for degreasing and de-rusting followed by one coat of primer and followed by one coat of epoxy paint. The colour of the paint shall be grey. | | | |
| 1.11 Suitable sitting arrangement: Bench & desk shall be provided inside the hut as per the drawing. | | | |

ANNEXURE-B**COMPLIANCE CHECK-LIST FOR SPECIAL TERMS & CONDITIONS**

| NIT Requirement | Compliance | | Vendors' Deviation/ Remarks |
|---|------------|----|--------------------------------|
| | Yes | No | |
| 1. Bidder to submit drawings with dimensions of the offered hut along with the bid for evaluation. Bid without drawings will be summarily rejected. | | | |
| 2. Bidder shall furnish the details of the materials to be used for fabrication of the huts along with the bid. | | | |
| 3. All the tubular members, angle irons, MS sheets etc. shall be painted with one coat of primer followed by two coats epoxy paints(Grey colour) for providing protection against the rust. | | | |
| 4. P.O & Sl. Nos. of the huts are to be embossed and written by welding on a visible space with date such as on the top of the doors. | | | |
| 5. In case of placement of order, the supplier shall prepare the detail engineering drawing, GAD, etc. of the hut. Drawings shall be sent to OIL for approval within 4 weeks from the receipt of Purchase Order and fabrication of huts shall be started after approval only. | | | |
| 6. Each hut shall be offered for inspection by OIL Engineer on completion of inside lining, painting etc. i.e. before final dispatching. | | | |

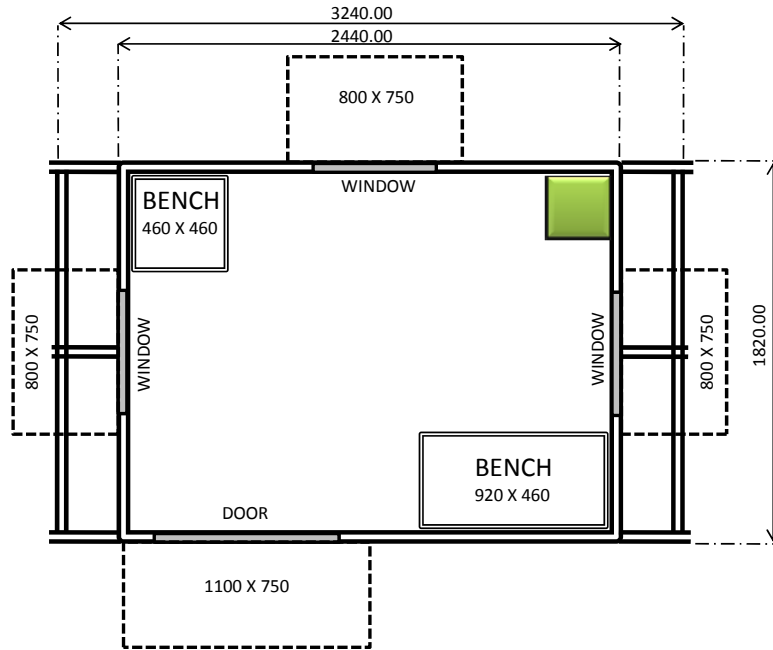

PLAN

All Dimensions are in mm

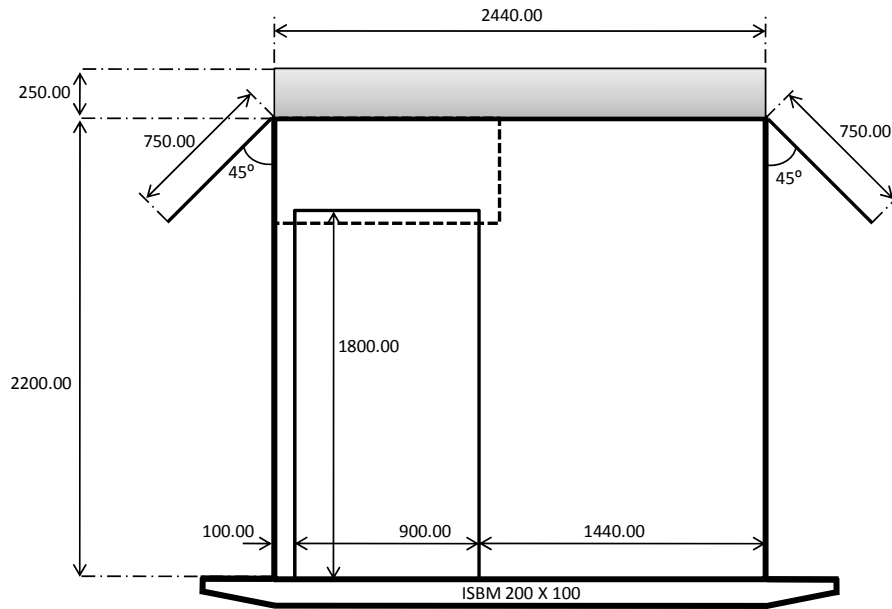

FRONT ELEVATION

All Dimensions are in mm

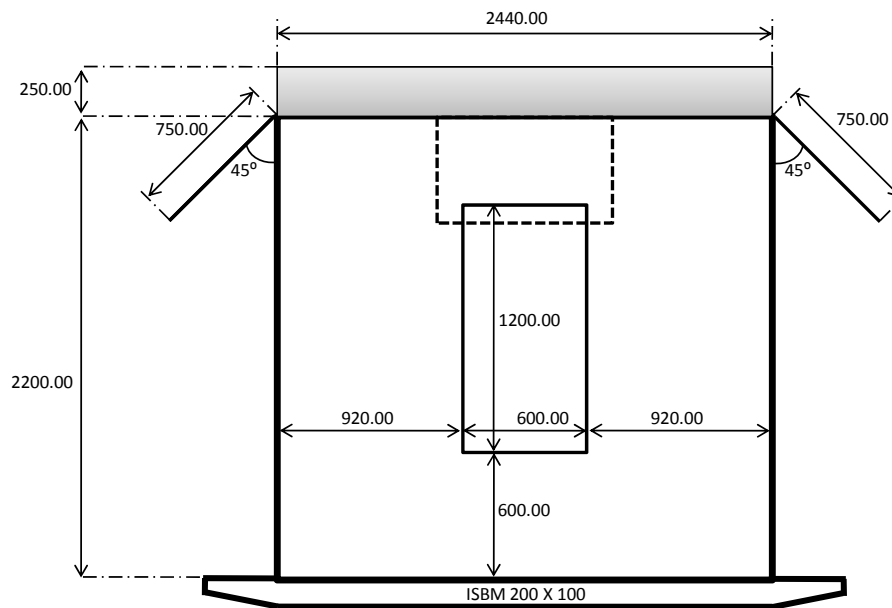

REAR ELEVATION

All Dimensions are in mm

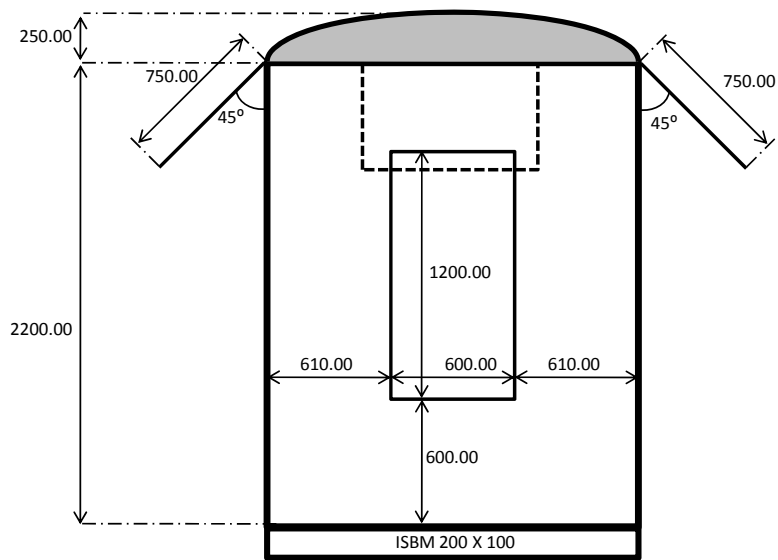

SIDE ELEVATION
All Dimensions are in mm