

**LAST DATE OF SUBMISSION:** 03.07.2024

**Sub:** Notice Inviting “Expression of Interest (EOI)” for “Hiring services for Establishment & Maintenance of Seismic Camp in OIL’s operational area in Assam & Arunachal Pradesh”.

**Introduction:** Oil India limited (OIL) is a premier National Oil Company engaged in the business of Exploration, Production and Transportation of Crude Oil and Natural gas. As a Maharatna Company under the Ministry of Petroleum and Natural gas, Government of India (GOI), it is the second largest national oil and gas company in India in the upstream sector as measured by total proved plus probable oil and natural gas reserves and production.

OIL (referred to as Company in the EOI) hereby invites Expression of Interest from experienced and reputed prospective Bidders for “Hiring services for Establishment & Maintenance of Seismic Camp in OIL’s operational area in Assam & Arunachal Pradesh”.

**SCOPE OF WORK:**

**DESCRIPTION OF JOBS UNDER SEISMIC CAMP ESTABLISHMENT & MAINTENANCE**

The Scope of work includes establishment and maintenance of seismic camps for housing OIL INDIA executives, staff along with crew resources like Equipment, ground electronics etc. among others in and around OIL’s PEL/ML and OALP areas in the states of Assam and Arunachal Pradesh for a period of two (02) years.

There shall be establishment of minimum two (02) nos. of seismic camps every year during the contract period. OIL expects the services to be provided under the scope of work for seismic Camp at par with international standards in line with OISD guidelines for Geophysical operations.

The contractor shall be responsible for providing plots of land for establishment of seismic camps with demarcated Boundaries and wired fencing in the boundary at mutually agreed locations (preferably within 30 km from the respective operational areas). The contractor shall be responsible for all other associated works/ services with the day-to-day running and maintenance of the Seismic Camp.

**NOTE:** OIL may hire same additional service of upto 50% of the total scope of this Contract for additional Seismic Camps to be established in OIL's PEL/ML and OALP areas in the states of Assam and Arunachal Pradesh as per requirement under the same terms and conditions stipulated in this tender/ contract with mutually agreed rates, terms, and condition, but with a rate not higher than the originally quoted rate.

#### **A. SEISMIC CAMP ESTABLISHMENT**

The contractor shall provide suitable, habitable seismic camp in the operational area for camping of company's personnel, office, housing of Equipment, ground electronics, vehicles among other and shall undertake seismic camp establishment & maintenance jobs at the campsite. Contractor shall provide 24 x 7 uninterrupted electric supply by electrical connection as well as backup eco-friendly generator for camp lighting (accommodation, office, kitchen, bathrooms, open area, along the periphery of the camp), equipment repairing, camp maintenance (running of ACs for accommodation, office and conference hall etc., powering of computers /printers/ other electrical/ electronic equipment), running of water supply pump, and charging of batteries etc. All expenses of electricity charges and land rent for camp establishment will be borne by the contractor during the period of Contract.

The seismic camp site will be in OIL's operational area in Assam & Arunachal Pradesh. OIL expects the services to be provided under the scope of work for the stand-alone Camp at par with international standards in line with OISD guidelines for Geophysical operations.

Company reserves the right to change the area of work during the field season due to technical reasons or circumstantial compulsions. In such events, inter location movement (ILM) shall be payable for shifting of contractor's material. However, contractor may have to undertake the jobs of re-establishment of the camp in new area and accordingly camp establishment charges shall be payable (only if the re-establishment of camp is done after completion of establishment of the camp at previous location).

The following are the responsibilities of the contractor for Seismic Camp establishment:

- i.** Contractor shall provide suitable habitable campground in the operational area of approximately three (3) hectares (dimensions should be preferably square in shape) for camping of Company's personnel, office, equipment, ground electronics, vehicles among others and shall undertake Seismic camp establishment & maintenance jobs at that camp site of the concerned Geophysical Party as per specifications mentioned in scope of work, under supervision of the OIL's representative. Contractor shall also provide 24 x 7 electric supply for camp lighting, equipment repairing, camp maintenance (running of ACs of living, offices etc., powering of computers/ printers/ other electrical/ electronic equipment), running of water supply pump, charging of batteries etc. Minimum 250 KVA electric power supply will be required for these purposes. No payment will be made by company for electric charges during the period of Contract. Contractor shall provide preparation of campground, cutting, cleaning, levelling, vehicular approach road making and barbed wire fencing of 6 ft. height (with material) as planned by the OIL's representative.

- ii.** The selected camp premises should be undisputed and have approachable road. It should not be low lying land.
- iii.** Supply/Construction of semi-permanent or temporary bunk houses /structures/ huts/ sheds for crew personnel, office, and seismic cable/ geophone repairs etc. with material and cement flooring of the huts/ sheds. The number of huts/ sheds to be constructed and their specifications are given in Table at Camp Specifications.
- iv.** Minimum six feet distance between each semi-permanent structures/ sheds/ bunk houses should be maintained to prevent spread of fire, for ease of walking/ movement of material etc.
- v.** Road making for heavy vehicles is the responsibility of contractor.
- vi.** No payment will be made by company for electric charges during the period of Contract. Contractor has to apply for electric connectivity and bear the cost of electrical connection to the camp. Contractor shall do all electrical wiring, connections and fittings (including material) of the entire camp including, temporary huts/ sheds etc. and its regular maintenance. All the necessary material for electric connections will be provided by contractor. All electric jobs are to be done by an electrician having a valid license.
- vii.** Contractor shall also provide necessary security deposit for connecting the main line of State Electricity Board to camp for which the necessary material will be provided by contractor. Contractor will ensure early restoration of power in camp.
- viii.** Camp should be properly fenced & guarded and should have at least one additional emergency exit gate.
- ix.** Contractor has to provide minimum three (03) nos. of tube wells (inclusive of material) and submit a certificate from local PHE about the quality of the water. If the quality of tube-well water is not up to the mark, contractor must arrange potable water supply from nearest supply source of PHE at its own cost round the clock. The contractor shall also make arrangement for the distribution of water at various points of use by electric motor pumps.
- x.** Contractor shall supply bed, table, chair made of wood or wrought iron, storage space and mirror to each bunk house/hut/ living room including the

bed rolls as per the commensurate of the occupancy. All living rooms and huts (except bunk house) should be provided/ fitted with one pedestal/ ceiling fan. The bed roll consists of minimum one mattress, two bed sheets, one mosquito net, two blankets/ quilt with cover and two pillows with cover.

**xi.** Contractor shall provide at least two tables, six chairs, one shelf/ rack, and one almirah etc. including two pedestal/ ceiling fans in each office bunkhouse as required. This will be done in consultation with the OIL’s representative.

**xii.** Contractor shall provide ACs in the following bunkhouses /rooms of the camp(s). Details of the amenities to be provided is attached as **Annexure-I** and **Annexure-II**. Accordingly electrical lines are to be laid down to take the load of ACs:

- a) Administrative Office
- b) Accommodation Bunkhouses
- c) Multipurpose (Discussion cum meeting) Bunkhouse
- d) Kitchen & Dining Bunkhouse

**xiii.** Contractor will provide one dining table with twelve chairs in the dining bunkhouse. The mess should be fitted with wash basins, mirror and fan etc as **Annexure-I** and **Annexure-II**.

**xiv.** Contractor has to provide the mirror, bucket, and mug etc. for use in toilets for all the crew personnel. He will provide all the items as per instruction of company representative and should be of good quality.

**B. CAMP ESTABLISHMENT SPECIFICATIONS**

Following huts and sheds are to be constructed for each camp establishment.

<b>BUNK HOUSE :</b>	
Type 1: Two separate rooms with single occupancy with attached toilet & bathroom for each room (30Ft x 10Ft)	4 No.
Type 2: Two separate rooms with double occupancy in each room (30Ft x 10Ft)	4 No.
Type 3: Two separate rooms with four occupancies in each room (30Ft x 10Ft)	3 Nos.
Type 4: Bunk House with fully furnished	2 Nos.

office set up (One (1) Bunk House with partition and One (1) Bunk house with no partition) (30Ft x 10Ft)	
Type 5: Bunk house as common area (Multipurpose Room) (30Ft x 10Ft)	1 No.
Type 6: Kitchen cum Dining Hall (12-seater) (30Ft x 10Ft)	1 Nos.

<b>HUTS:</b>	
a) Security Hut (40' x 20') with 6' Verandah	1 No.
b) Ground Electronics Godown with 4 feet veranda (20' x 50')	2 Nos.
c) Recreation Hall (40' x 20') with 6' Verandah	2 No.
d) Kitchen cum dinning hut (40' x 15') with 6' Verandah	6 No.
e) Bathrooms (6' x 4')	20 Nos.
f) Toilet (latrine) (6' x 4')	20 Nos.
g) Store – cum- Laundry Hall (20Ft x 15Ft) with 6' Verandah	1 No.
h) Battery and Radio Room (30Ft x 10Ft) with 6' Verandah	1 No.
i) Survey Equipment Room (15Ft x 10Ft) with 6' Verandah	1 No.
j) Testing and Maintenance Room (15Ft x 10Ft) with 6' Verandah	1 No.

<b>SHEDS:</b>	
a) Instrument Van / Vehicle parking shed (60' x 12' x 15')	1 No.
b) Generator shed (15' x 20')	2 No.
c) HSD Storage shed (12' x 15')	1 No.
d) Equipment Storage shed (20' x 20')	1 No.
e) Workshop (30' x 20')	1 No.
f) Security Shed/Morcha (minimum)	6 No

## **B.1 General specifications of Living/ Office bunk houses and huts:**

### **Common for Bunk and Hut**

- i. All the above bunk houses and huts should be raised at least 1 feet height from the ground level.
- ii. The flooring should be done with cement flooring. There should not be any hole/ gap in the floor level so that snakes, frogs etc. cannot enter into the hut/bunk house.

### **Bunkhouse**

- i. The bunkhouses should be Air-conditioned and fully furnished. Electrical and furnishing specifications to be provided as per **Annexure-I** and **Annexure-II**.

### **Hut**

- ii. The roofs are to be fitted with Galvanized sheets and should be placed in a slanting position from 12 feet to 10 feet. The false ceiling height of the huts should be 8 ft. The roofs of the living huts, walls and sheds should be completely waterproof. The ceiling should be made of thermocol to prevent the room from heat and cold. Windows should be fitted to the living huts for proper ventilation. Chhajja (sunshades) should be made over windows and doors so that water cannot enter into the hut during rain. The Chhajja over the door should be at 7 feet height so that it should not hurt any part of the body of any normally tall person.
- iii. All office huts should have brick walls/cemented thatch wall of height of up to 10 feet with fireproof false ceiling. All the doors and windows are to be made of

wood.

- iv.** The depth of the foundation must be minimum 1 foot deep.
- v.** Separate toilet and bathroom to be constructed as per camp establishment specifications. The location of the separate toilets and bathrooms will be as per company representative's prerogative in mutually consultation with service provider.
- vi.** All huts must be properly ventilated.
- vii.** Workshops and battery rooms must be provided with at least two windows (2' x 2') on each of the longer sides.
- viii.** Electrical specifications to be provided as per **Annexure-III**.

## **B.2 General specifications of sheds:**

- i.** All the sheds should be raised at least 1 feet height from the ground level.
- ii.** Wall should be constructed in all the sides of the sheds with galvanized sheets.
- iii.** The flooring should be done with cement flooring / ceramic tiles. There should not be any hole/ gap in the floor level so that snakes, frogs etc. cannot enter into the hut.
- iv.** The roofs are to be fitted with Galvanized sheets and should be placed in a slanting position from 12 feet to 10 feet. The roofs of the sheds should be completely waterproof. Windows should be fitted to the shed for proper ventilation.
- v.** All the doors and windows are to be made of wood/steel/Aluminum/PVC.

## **B.3 Specification of Latrine (Toilet) cum Bathroom attached with bunk & hut:**

- i.** Latrine (Toilet) cum Bathroom of bunk houses should have all amenities with material including sewerage, hot water geyser and proper light. Each Latrine (Toilet) cum Bathroom is to be fitted with taps connected with the water storage tanks, Western style commodes along with faucet. WCs are to be connected to sewerage, septic tank, and soak pit.
- ii.** Latrine (Toilet) and Bathroom hut should have all amenities with material including sewerage, cement flooring / tiles and proper light. Each Latrine (Toilet)

cum Bathroom hut is to be fitted with taps connected with the overhead water storage tank. Latrine (Toilet) are to be connected to sewerage, septic tank, and soak pit.

- iii. The bath, necessary (latrine) huts are to be constructed in different blocks at respective locations and each block should have 24x7 running water supply.

#### **B.4 Specifications of kitchen & dining bunks and huts:**

- i. Bunk houses and huts for Mess is to be fitted with suitable number of taps and wash basins and the taps are to be connected with a water storage tank of minimum 1000 liter capacity to be placed on an iron/ wooden structure at a height of 15 feet that will get water supply through a pump. The roof of water storage tank should be covered with Galvanized sheet with waterproof false ceiling.
- ii. Mess hut is to be fitted with suitable number of taps and wash basins and the taps are to be connected with an overhead water storage tank of minimum 1000 liter capacity to be placed on an iron/ wooden structure at a height of 15 feet that will get water supply through a pump. The roof of water storage tank should be covered with Galvanized sheet with waterproof false ceiling.
- iii. Kitchen area should be provided with suitable platform for cooking and placing gas stove along with necessary storage for utensils, grocery items and other kitchen appliances.
- iv. Kitchen & dining bunks and huts should have 24x7 running water supply.

#### **B.5 Specifications of Cement Flooring of huts:**

Brick flat soling, joint should be filled up with cement mortar and ½” cement plastering on the brick walls and floors.

## **B.6 Construction of Internal Paths:**

- i.** Pucca foot paths in front of all living huts/ sheds are to be constructed up to the entrance of the camp and all office huts. Also pucca foot paths are to be constructed for connecting living huts to toilet/ bath room.
- ii.** Construction of internal path is to be done in consultation with OIL's representative.
- iii.** All the material including bricks, wooden doors and windows, tube wells, huts and sheds supplied by the contractor during camp establishment will be the property of the contractor. Company does not have any liability and responsibility for its loss & disposal at the time of Demobilization.

### **The following are the responsibilities of contractor:**

- i.** The selected campground should be undisputed and have approachable road. It should not be low lying land.
- ii.** Preparation of campground, grass / bush cutting, cleaning, levelling, approach road making and fencing (with barbed wire) (minimum area of the ground -3 hectares) as per the instruction of company representative.
- iii.** Making vehicular approach road suitable for plying heavy vehicles from the campsite to the nearest metalled / un-metalled road with required material.
- iv.** Parking space for around 80-100 nos. of vehicles need to be prepared inside the camp.
- v.** The number of bunks/huts/ sheds to be constructed and their specifications are given above. Tentative diagrams of the bunkhouses are enclosed as **Annexure-IV**.
- vi.** 3 feet deep and 2 feet wide trenches should be made all around the camp for protection from snakes and reptiles etc.
- vii.** Fencing up to 6 ft. height with materials (barbed wire/net) of the entire camp ground, and double fencing using barbed wires.
- viii.** Designated assembly points should be made inside the camp.
- ix.** Eco-friendly generator(s) of 250 KVA must be provided and installed by the contractor in the camp. The contractor must provide 24x7 electricity in the entire camp. Maintenance of gensets must be considered and backup gensets must be provided accordingly.

- x.** Contractor shall do all electrical wiring, connections and fittings of the entire camp including huts, tents, sheds, solar system etc. and its regular maintenance. All the necessary material for electric connections will be provided by contractor. These jobs are to be done by an electrician having valid license.
- xi.** The Contractor has to provide electrical points for PC, Printer with scanner with all other office furniture for the office set up as mentioned in **Annexure-I** and **Annexure-II**.
- xii.** CCTV facilities at the Camp should be available and provided by the Contractor.
- xiii.** All electrical wiring of the camp should be done according to Indian Standards 732, Code of Practice for Electrical Wiring. The wires used for camp electrification should be of proper specification having BIS mark.
- xiv.** CEA safety reg. 2010 (or its latest version) to be followed wherever applicable.
- xv.** At least three core PVC insulated and PVC sheathed wires should be used for electric wiring.
- xvi.** Each line should be strictly installed with earthing wire. Fuse of proper rating should be used for each line.
- xvii.** Electrical load of the camp lighting is to be distributed properly to avoid accident. Main panel board must be away from the living room.
- xviii.** Earthing connections for entire camp area must be done properly.
- xix.** The switchboards must be neatly fitted with adequate number of panels and wiring must be properly fitted on it. Main switchboard should be facilitated with E.L.C.B. (Earth Leakage Circuit Breaker).
- xx.** Every circuit should be protected against overcurrent by automatic tripping devices.
- xxi.** Insulating mats conforming to IS: 15652:2006 having BIS mark shall be provided near the electric control panel.
- xxii.** For the recreational hut, minimum one table tennis board, one carom board, multigym facilities must be provided.
- xxiii.** Badminton court and volleyball court along with other required sports items has to be provided by the contractor in the campground.

### **C. CAMP MAINTENANCE**

**Camp Maintenance** of Seismic Camp shall be required during operational Field Season (November to May). The payment towards camp maintenance section shall be paid on monthly basis.

The contractor shall carry out the following camp maintenance activities for smooth seismic field operations:

- i.** The contractor shall provide 24 x 7 uninterrupted running water and electric supply.
- ii.** Total camp maintenance including housekeeping of all the living and office huts etc. on daily basis round the clock.
- iii.** To ensure round the clock availability and distribution of potable water of BIS mark as per requirement for drinking purposes.
- iv.** Maintenance of AC units of 1 to 2 tons capacity including minor repairs like checking and cleaning of air filters, gas checking/ filling, checking of stabilizer, supply of electricity, checking of timer and power cord etc. as and when required.
- v.** High Speed Wi- Fi of minimum 300 Mbps speed should be available at the Camp. Minimum 20 users to be considered for hi-speed Internet Services.
- vi.** 250 KVA eco-friendly silent generator should be placed at one corner of the camp in a separate shed and proper mountings and earthing shall be provided as per OISD-STD-137. Generator room must have sufficient space and only authorized persons should be allowed to enter the room.
- vii.** Maintenance and repair of 250 KVA eco-friendly silent generator in the camp with required stack height as per Environment Protection Rules 1986. Spares if required, for repairing the generators, will be provided by contractor.
- viii.** Toilet and bath huts/bunks are to be sprayed every day with disinfectants.
- ix.** Spray for controlling of pest / mosquitoes/ insects are to be done thrice a week in all living bunk house/huts/ office huts/ sheds etc.
- x.** Disinfectant agents and pest control spray is to be provided by contractor.
- xi.** Installation and maintenance of fire extinguishers, sand bucket and water buckets (3 sets) as per the directive of the company representative. Minimum 12

nos. of fire-extinguishers (8 nos. DCP & 4 nos. CO2) should be kept at strategic locations of the camp. (Kitchen 1 DCP & 1 no CO2, Office 2 DCP & 1 CO2, Gen-set 2 DCP & 1 CO2, living area 3 DCP & 1 no CO2).

- xii.** Lightning arrestors, insulation mats, wind socks and other necessary safety items as deemed necessary by company representative must be provided.
- xiii.** Protection against the risk of theft and pilferage of camp material and equipment.
- xiv.** Daily cleaning of camp premises, sanitary cleaning (twice a day), cleaning, housekeeping and maintenance of living huts, sheds, camp offices including recreation and common dining areas.
- xv.** Housekeeping includes regular cleaning and maintenance of linens, mattresses, upholstery and amenities.
- xvi.** Providing sufficient armed security guards for round the clock camp security for the entire contract period. Min two (2) security guards must be always provided in each of the main gate, emergency exit gate and security morchas.
- xvii.** Other miscellaneous jobs or any sundry jobs for camp maintenance as required by the company representative.
- xviii.** Electrician with valid license and other licensed persons shall be available round the clock in the camp to attend regular maintenance and emergency electrical jobs.
- xix.** The Contractor will arrange on their own for proper disposal of all types of waste generate in the Camp.
- xx.** Contractor at the campsite shall provide suitable First aid medical service. The Contractor shall make available at all times during entire contractual period sufficient quantity of first aid equipment & medicine to meet any emergency.
- xxi.** The Contractor shall be responsible for any theft or loss of company resources and company personnel belongings and shall have to reimburse the same to the concerned person or to the Company as per company inspection report.
- xxii.** The Contractor shall be responsible for any normal wear and tear of the contractor's resources. Any damage caused while transportation and due to the negligence of contractor personnel shall be the responsibility of the contractor.
- xxiii.** The contractor shall replace/repair any damaged equipment at its own cost within 14 days. Any type of repairing due to damage to the huts/bunkhouses/sheds

shall be the contractor's responsibility.

**xxiv.** The Contractor shall deploy one site in charge who will be responsible for all contractual obligations and maintenance of camp. The site in charge must be available 24x7 in the camp site and will be single point of contact for resolving any issues raised by company representative. Arrangement of necessary accommodation, food and all other requirements of its own personnel shall be the sole responsibility of the contractor.

**SOR for hiring Services for SEISMIC CAMP ESTABLISHMENT & MAINTENANCE**

<b>Sl No.</b>	<b>Item Description</b>	<b>Qty</b>	<b>Unit</b>	<b>Price (INR)</b>
10	Camp Mobilization*	4	Lumpsum	
20	Camp Establishment**	4	No	
30	Charges against maintenance of each camp per month during operational Field Season (November to May) {(7 months x 2 years) x 2 camps}	28	No	
40	Standby Charges each camp per month during non-operational Field Season (June to October) {(5 months x 2 years) x 2 camps}	20	No	
50	Inter Location Movement	2	No	
60	Camp Demobilization***	4	Lumpsum	

**Notes:**

\*Camp Mobilization (2 years x 2 camps each year) = 4

\*\*Camp Establishment (2 years x 2 camps each year) = 4

\*\*\*Camp Demobilization (2 years x 2 camps each year) = 4

- i.** The **mobilization** includes arranging appropriate land with fencing & landscaping, supply and installation of bunk houses, gensets, power supply, water supply for establishment of camp at mutually identified camp site within 90 days from the LOI (letter of Intimation). **Mobilization** shall be deemed to be

completed when contractor will supply all bunk houses, huts, sheds, kitchen, toilets, pathway, security arrangement, landscaping, water supply, genset, electrical setup and other required infrastructure in readiness to commence the service as envisaged under the contract duly certified by the company's authorized representative. The contractor shall be provided with a mobilization certificate by concerned company representatives after which payment for mobilization can be made.

- ii. Camp establishment** shall be deemed to be completed when contractor will supply all bunk houses, huts, sheds, kitchen, toilets, pathway, security arrangement, landscaping, water supply, genset, electrical setup and other required infrastructure in readiness to commence the service as envisaged under the contract duly certified by the company's authorized representative.
- iii. Camp Maintenance during operational Field Season (November to May)** includes all services mentioned under CAMP MAINTENANCE section. The payment towards camp maintenance section shall be paid on monthly basis.
- iv. Standby Charges per month during non-operational Field Season (June to October)** All facilities including but not limited to electricity supply, water supply, bunkhouses, huts, sheds must be maintained in ready to use condition throughout the standby period. Contractor shall arrange for all facilities to accommodate up to six (6) company personnel throughout the standby period. The payment towards camp maintenance section shall be paid on monthly basis.
- v.** In case the camp is operated/on standby for any period other than the mentioned operational and non-operational months, payment will be done on pro rata basis i.e. on the basis of number of days of the respective operational/non-operational month.
- vi. Inter Location Movement** includes transfer/shift of a camp with all requisite items from one location to another during the execution of contract period.

**vii. Demobilization** charge is all-inclusive lump sum basis for the expenditure to be incurred by the contractor towards removal of all their resources and restore the camp site.

### **Annexure-I: Electrical specifications of Bunkhouses**

Type of Bunk House	3 pin / 6 A Multiplug Sockets with Switches (Make: Havells / Legrand/ Syska/ Phillips or equivalent ISI rated make)	1 / 5 / 1 6 A Switch Socket (Make: Havells / Legrand/ Syska/ Phillips or equivalent ISI rated make)	20 A Metallic Socket for AC with RCB 0 (Make: Havells / Legrand / Syska/ Phillips or equivalent ISI rated make)	Wall/ Ceiling Mounted Fan (Make: Usha/ Crompton /Bajaj/ Orient or equivalent ISI rated make)	Air Conditioner BEE rated for a minimum 3-star of latest ratings (Make: Voltas / LG / Blue star / Carrier / Panasonic / Daikin / Llyod / Haier or equivalent ISI rated make)	LED light (Make: Havells / Crompton Greaves /Bajaj or equivalent ISI rated make)	Exhaust Fans (Make: Havells / Bajaj or equivalent ISI rated make)	Geyser (Make: Crompton/ Havells/ Bajaj or equivalent ISI rated make; Capacity: Up to 10 Liters)
Type 1: Two separate rooms with single occupancy in each	2 in each room	0	1 in each room	1 in each room	As per size of the bunk house rooms	1 in each room	1 in each bathroom	1 in each bathroom
Type 2: Two separate rooms with double occupancy in each	2 in each room	0	1 in each room	1 in each room	As per size of the bunk house rooms	1 in each room	1 in each bathroom	0
Type 3: Eight Occupancy	4 in each room	0		1 in each room	As per size of the bunk house rooms	2 in each room	0	0
Office with partition	3 in each room	0		1 in each room	As per size of the bunk house rooms	2 in each room	0	0
Office with workstations and no partition	12	1 in room	1 in each room	1 in room	As per size of the bunk house rooms	4 in room	0	0
Kitchen & Dining	1 in Kitchen, 3 in Dining room	2 in Dining room	1 in each room	2 in Dining room	As per size of the bunk house rooms	2 in Kitchen and 2 in Dining room	1 in Kitchen	0

Multipurpose Bunkhouse	6 in room	1	1 in room	1 in room	1 in room	4 in room	0	0
---------------------------	-----------	---	-----------	-----------	-----------	-----------	---	---

## **Annexure-II: Furnishing Specification of Bunkhouses**

Type of Bunk House	Table (Make: Godrej or equivalent top-rated make)	Wardrobe (Make: Godrej or equivalent top-rated make)	Chairs (Make: Godrej or equivalent top-rated make)	Beds with mattress (Bed length minimum 6.5 Feet; Mattress Make: Kurlon/ Sleepwell/ Wakefit/ Godrej or equivalent top-rated make; Quality: Orthopaedic/ Memory foam; Hardness: Medium Hard)	Bathroom furnishings (Make: Hindware or equivalent top-rated make)
Type 1: Two separate rooms with single occupancy in each	1 (4'Lx2Wx2.5'H) in each room What size	1 (2.5'Lx2'Wx2.5'H) in each room size	1 in each room	1 Bed (6.5'Lx3'Wx2.5'H) with box storage in each room Size	One wash basin, one mirror, Western style toilet, adequate no of water taps in each bathroom
Type 2: Two separate rooms with double occupancy in each	1 (4'Lx2Wx2.5'H) in each room	1 (2.5'Lx2'Wx2.5'H) in each room	1 in each room	2 Beds (6.5'Lx3'Wx2.5'H) with box storage in each room	One wash basin, one mirror, Western style toilet, adequate no of water taps in each bathroom
Type 3: Eight Occupancy	1(4'Lx2Wx2.5' H) in each room	2 (2.5'Lx2'Wx2.5'H) in each room	2 in each room	Two (2) numbers of two tier bunk beds (6.5'Lx3'Wx2.5'H) in each room	Not Applicable
Office with partition	2 (4'Lx3'Wx2.5' H) Long Office table in each room	2 (2.5'Lx2'Wx2.5'H) in each room	4 Office Chairs in each room	Not Applicable	Not Applicable
Office with workstations and no partition	3 (4'Lx3'Wx2.5'H) Long Office table	1 (2.5'Lx2'Wx2.5'H) in each room	8 Office Chairs	Not Applicable	Not Applicable
Kitchen & Dining	Dining Table with 12 seat capacity (10'Lx4'Wx2.5'H )	Adequate storage facility in kitchen for storage of food, utensils, and other kitchen materials	12 in Dining room	Not Applicable	1 Kitchen Wash basin, 2 dining room wash basin with adequate nos. of water tapes.
Multipurpose Bunkhouse	1 Office Table (4'Lx3'Wx2.5'H), 1 Long Table (10'Lx4'Wx2.5'H ) for conference	1 in room	14 in room	Not Applicable	Not Applicable

Note: Adequate no of toiletries, room fresheners, mosquito nets, door mat, curtains, pillows with pillow covers, bedsheets, blankets, wall hangers and other necessary items must also be provided for the entire contract period.

**Annexure-III: Electrical specifications of Huts**

Type of Huts	3 pins 5/6 A Multiplug Sockets with Switches (Make: Havells / Legrand/ Syska/ Phillips or equivalent ISI rated make)	15/16A Switch Socket (Make: Havells / Legrand/ Syska/ Phillips or equival ent ISI rated make)	20 A Metallic Socket for AC with RCB 0 (Make: Havells / Legrand/ Syska/ Phillips or equivalent ISI rated make)	Wall/ Ceiling Mounted Fan (Make: Usha/ Crompton Greaves /Bajaj/ Orient or equivalent ISI rated make)	Air Conditioner BEE rated for a minimum 3- star of latest ratings (Make: Voltas / LG / Blue star / Carrier / Panasonic / Daikin / Llyod / Haier or equivalent ISI rated make)	LED light (Make: Havells / Crompto n Greaves /Bajaj or equivale nt ISI rated make)	Exhaust Fans (Make: Havells / Crompto n Greaves /Bajaj or equivale nt ISI rated make)	Geyser (Make: Crompto n/ Havells/ Bajaj or equivale nt ISI rated make; Capacity: Up to 10 Liters)
Security Hut	8	0	0	8	0	8	0	0
Ground Electronics Godown	8	0	0	0	0	4	0	0
Recreation Hall	8	0	0	8	0	4	0	0
Kitchen cum dinning hut	4	1	0	2	0	4	0	0
Store – cum- Laundry Hall	8	1	0	8	0	4	0	0
Battery and Radio Room	8	24	0	0	0	4	0	0
Survey Equipment Room	8	1	0	0	0	2	0	0
Testing and Maintenanc e Room	8	1	0	2	0	2	0	0

## Annexure-IV: Tentative Diagram of Bunkhouses

Bunk House Type 1

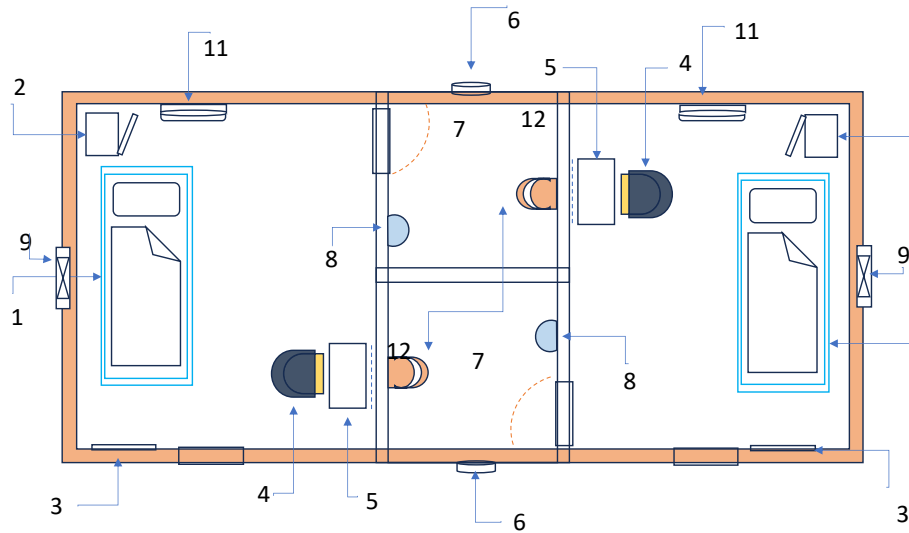

1. Bed with box storage.
2. Almirah
3. TV
4. Chair.
5. Study Table
6. Exhaust
7. Toilet & bathroom.
8. Sink
9. Window
10. Door
11. AC
12. EWC with hung cistern

Bunk House Type 2

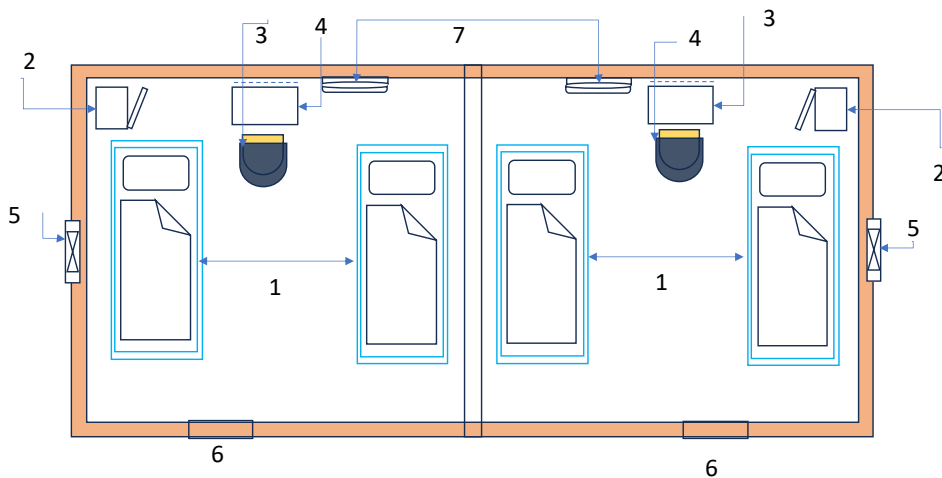

1. Bed with box storage.
2. Almirah
3. Study Table
4. Chair.
5. Window
6. Door
7. AC

**Bunk House Type 3**

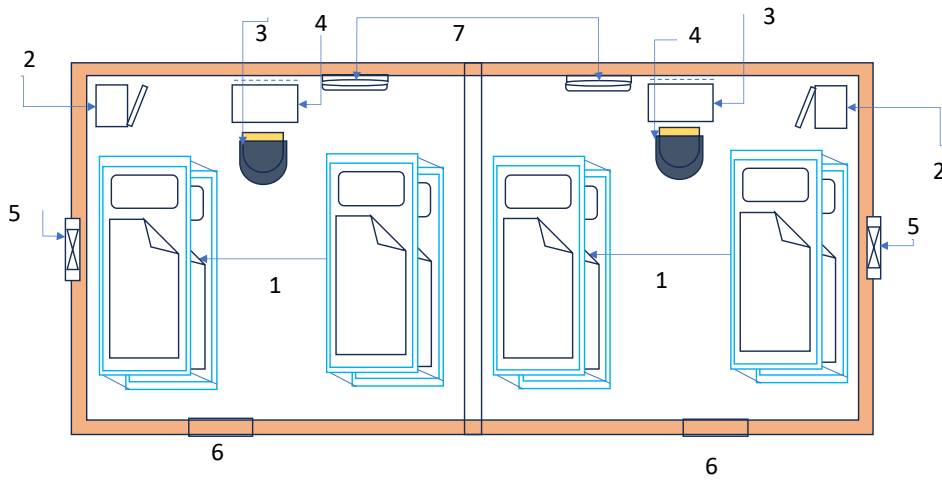

- 1. Bed with box storage.
- 2. Almirah
- 3. Study Table
- 4. Chair.
- 5. Window
- 6. Door
- 7. AC

**Bunk House Type 4 (partitioned)**

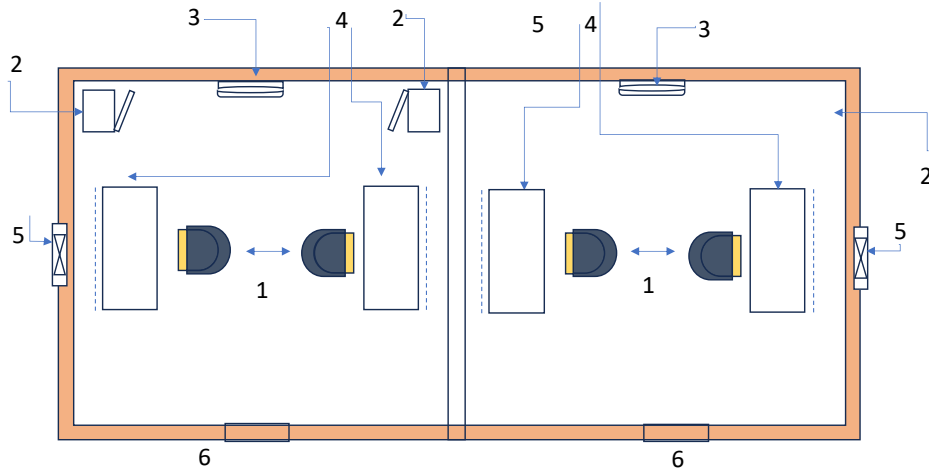

- 1. Chair
- 2. Almirah
- 3. AC
- 4. Office Table
- 5. Window
- 6. Door

**Bunk House Type 4  
(Non-Partitioned)**

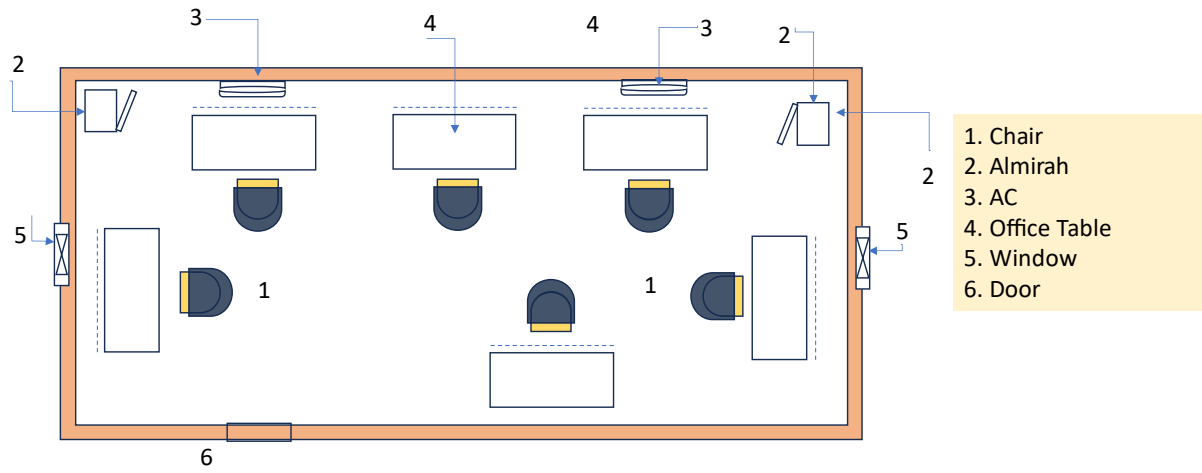

**Bunk House Type 5  
(Multipurpose Room)**

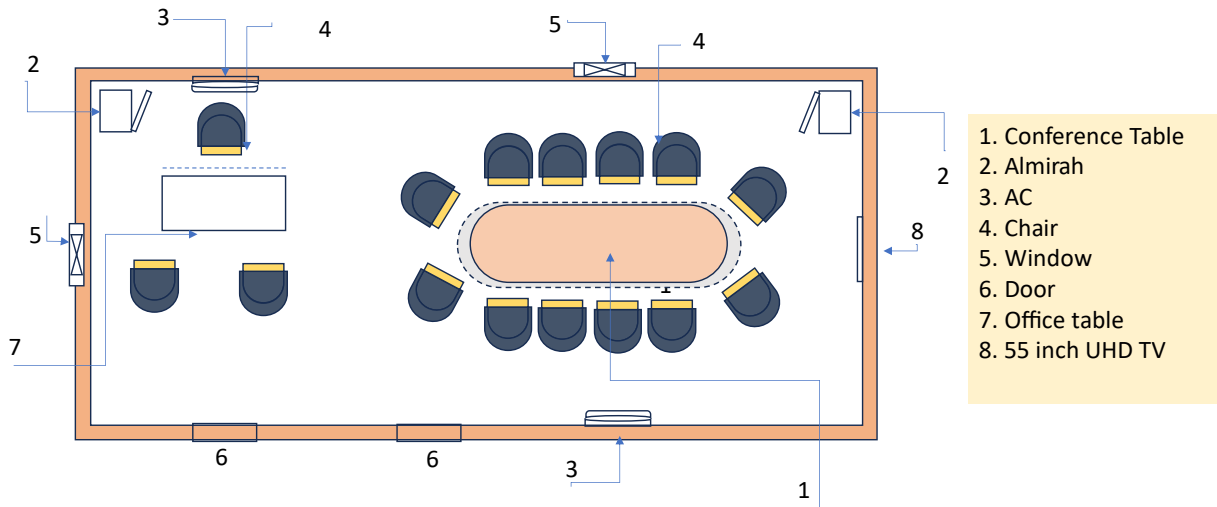

Bunk House Type 6

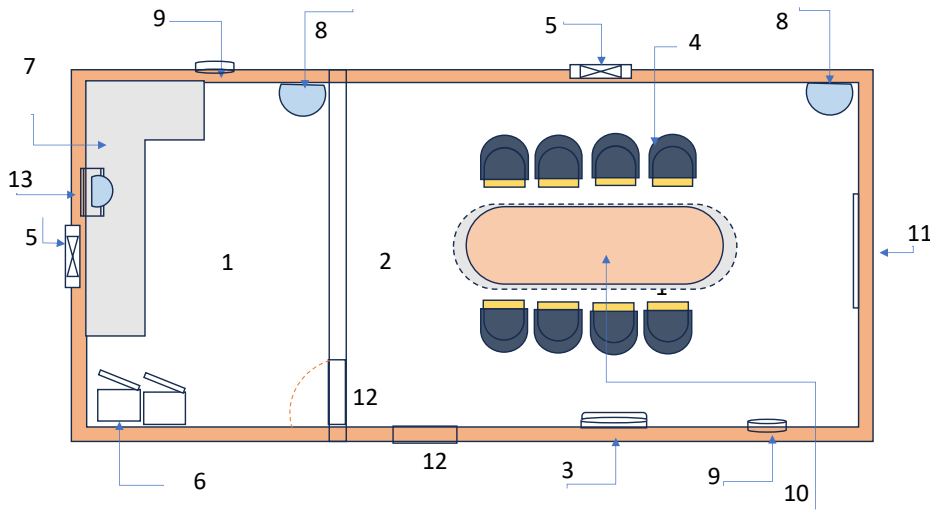

- 1. Kitchen
- 2. Dining hall
- 3. AC
- 4. Chair
- 5. Window
- 6. Storage
- 7. Kitchen Slab
- 8. Sink
- 9. Exhaust
- 10. Centre Dining Table
- 11. 55-inch UHD TV
- 12. Door
- 13. Chimney

**Address for Communication:** Interested Bidders are requested to submit their Expression of Interest along with budgetary quotations latest by 03.07.2024 to the following address:

**Chief General Manager (Geophysics)**  
**Oil India Limited,**  
**Duliajan, Dibrugarh, Assam-786602**

The last date for submission through post on the above address is 03.07.2024. The expression of Interest along with all requisite documents and any other queries may also be sent through e-mail to the e-mail id [hgp\\_office@oilindia.in](mailto:hgp_office@oilindia.in) with subject of mail “Expression of Interest for Hiring services for Establishment & Maintenance of Seismic Camp in OIL’s operational area in Assam & Arunachal Pradesh” within the closing date and time of this invitation of EOI.